

Homeowners Guide

用户手册

VEIL+ INTELLIGENT TOILET

新维亚智能坐便器

K-5401T-5-HB1

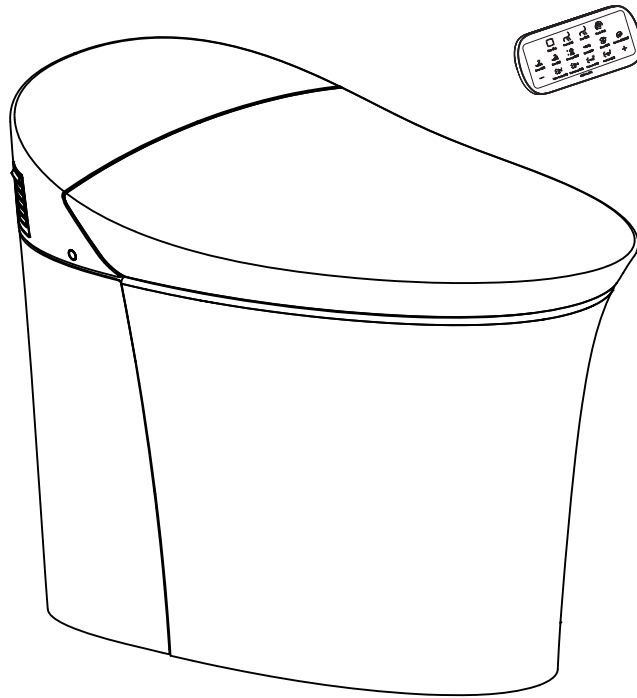

科勒（中国）投资有限公司

中国上海市静安区江场三路158号 邮编：200436

制造商：上海科勒电子科技有限公司

中国上海市宝山区丰翔路1955号 邮编：200444

English page 2-23

中文页码 24-45

1663385-T5-A

THE BOLD LOOK
OF **KOHLER**®

Contents

Cautions and warning.....	3
Specification.....	5
Thank you for choosing Kohler Company.....	6
Overall diagram.....	6
Guide on usage of remote controller.....	7
Guide on setting of remote controller.....	8
Preparations before initial use.....	10
Function for opening/closing of cover/seat.....	11
Flushing of toilet.....	12
Auxiliary keyboard function.....	15
Standby mode.....	15
Sanitize function.....	15
Sterilization by sterilized water.....	16
Automatic energy saving function.....	16
Maintenance and cleaning.....	16
Trouble shooting.....	21
Description of Content of Hazardous Substances in Product	23

Cautions and Warnings

Save this instruction



Warning: Risk of electric shock, fire or personal injury. This product must be installed safely. Connect only to dedicated 220V~, 50Hz, 10A circuit protected by Ground-Fault Circuit-Interrupters (GFCI's) or Earth-Leakage Circuit-Breakers (ELCB's).



Warning: Risk of electric shock or product damage. Do not immerse the product into water.



Warning: Do not use any hard setting material (cement mortar) while installing the toilet. Thermal expansion of hard setting material (cement mortar) will damage or crash the feet of toilet. Kohler will not be responsible for any damage because of using hard setting material (cement mortar) for toilet installation.



Warning: Risk of product damage. Do not throw into the toilet what that will cause the toilet to block such as newspapers and sanitary towel. Do not bump the vitreous china with great force as it will cause damage and leaking.

Important! Risk of product damage. Do not install at a place where it may be splashed by water.

Important! Risk of product damage. Do not install the product at a place with excessive humidity, where moisture may condense at the surface of the product. Please maintain that the usage environment is under adequate ventilation, so as to prevent damage to electronic components.

Important! Risk of product damage or property loss. Water leakage may happen if the water pipe connector is pulled or pushed with excessive force.

Important! Risk of product damage. The product may be damaged if the nozzle is applied with excessive force.

Important! Risk of product damage. The part of the pipe where water may be frozen should be protected by thermal insulation. Any water left in the product may be frozen during the winter season. Please keep the product in room temperature before reinstallation or usage.

Important! Risk of product damage. The power shall not be connected before the work is finished. Otherwise it may lead to product failure.

Attention: The thermal protector may be out of order during storage or transportation in warm climate which can lead to product failure. Please ensure the product cools to room temperature before reinstallation or usage.

When an electrical product is used, especially when children are near, the following basic safety precautions shall be abided by:

Danger-Reduce risk of electric shock:

- Do not place or store this appliance where it can fall or be pulled into a bath or sink.
- Do not place in or drop into water or other liquid.
- Do not reach for a product that has fallen into water. Unplug immediately.

WARNING - To reduce the risk of low grade burns, electric shock, fire or injury to persons:

- Children, elders or those with disabilities from their body, sensitivity or mental disabilities or lacking of common sense should not use or get close to this product unless under close tutelage. Children are not allowed to use or touch this product. Do not leave children alone in a room with such product.

CAUTIONS AND WARNINGS (cont.)

- For those children and the elderly who are unable to adjust the temperature, they should ask for help to adjust seat temp, water temp and wind temp of toilet cover to proper gears.
- Use this appliance only for its intended purpose as described in the manual. Do not use attachments not recommended by Kohler Co. such as angle valve etc.
- Do not lean on cover when use this appliance to prevent product from damage.
- Never operate this appliance if it has a damaged cord or plug, if it is not working properly, if it has been dropped into water.
- Install this product properly by following the installation procedure.
- This product shall be repaired by professionals only. The warranty will become invalid if you try to repair this product by yourself.
- When install the product in the room, a stop valve shall be installed in a close proximity. For emergency circumstances, the water inlet valve shall be stopped without using any tools; otherwise unexpected failure may cause the loss to the customer.
- Keep power line far from heated surface.
- Do not drop or insert any substance to pipeline or the opening.
- Do not use this product outdoor or in a place where a particle mist spray device is used, neither at a place of provisions.
- The installation should be subject to the instructions before the power is connected.
- Water should not be poured into the power plug.
- Exposed skin should not make contact with heating seat for too long a time to prevent low temperature burning.
- UV sterilization devices should be installed and maintained by qualified service personnel.
- In case the power line is damaged; to avoid danger, product should be replaced by the manufacturer or the professionals from its maintenance department or similar departments, to avoid the occurrence of danger.
- Please use the water supply hose accompanying with new machine. The old hose assembly shall not be used again.
- When customer cut power supply off, if reactivation of power supply is required, please wait until the end of "beep....." indication, and then turn on power supply again.

Specification			
Flush volume		4.0L	
Water efficiency grade*		Level II	
Pit distance		305mm	
Water pressure		Min water pressure 0.07MPa (dynamic pressure) Max water pressure 0.74MPa	
Rated voltage		220V~, 50Hz	
Rated power*		1090W	
Length of power line		About 1.3m	
Product outline dimension		About 670mm × 438mm × 533mm	
Weight of product		About 48kg	
Inlet water temp		1-35°C	
Operation Environment		1-40°C	
Cleaning	Rear wash		YES, adjustable
	Spiral wash		YES, adjustable
	Front wash		YES, adjustable
	Water flow (water pressure 0.2MPa)		Max rear wash shall be no less than 500mL/min
	Adjust cleaning water temp		OFF, adjustable 5 dials (ambient temp, about 31-39°C)
	Cleaning time (Max)		About 300s
	Adjustment of nozzle position		5 gears
	Impulse massage		On/Off
	Wand oscillate		On/Off
	Safety device	Water temp overheat protection	
Prevention of backflow		Check valve	
Comfort	Thermal	Temp adjustment	OFF, adjustable 5 dials
		Safety device	Thermal fuse
	Cover		Automatic open/close, slow swing, remote open/close
	Seat		Slow swing, remote open/close
	Dryer	Dryer function	Yes
		Safety device	Thermal fuse
	Deodorizing function		Yes
Remote controller		For functional setting, see Page 8-9	
Sanitation	Self-cleaning of nozzle		Yes
	Antibacterial materials		Seat and cover
	sterilized water		Yes
	UV sanitize		Yes
Other	Other safety devices		Circuit-Breakers
	Auxiliary keyboard		Yes
	Seating detection		Located inside the seat
	Night light		Yes
	Auto cover opening/closing		Microwave sensing
	Manual flush		Yes
	IOT function		Only K-5401T-5XP-0

* The description of water efficiency label marked on intelligent toilet: water efficiency label represents a compliance mark of the water efficiency grade etc. performance of intelligent toilet.

* Power value testing condition: dynamic pressure 0.2MPa, inlet water temp 15°C.

Thank you for choosing Kohler Company

Thank you for choosing Kohler. Kohler technology provides reliable performance and elegant life, satisfying your demand now and into the future. Aesthetics and reliability of Kohler products will surely satisfy your personal style. We are very proud of Kohler products and you will be as well.

Please take a few minutes to read this user manual and pay special attention to the maintenance and cleaning instructions.

All information in this instruction is based on the latest published product information. We always persist in improving the quality of all Kohler products. We reserve the right to change product features, packaging or practicability of products at any time without making notification.

Overall diagram

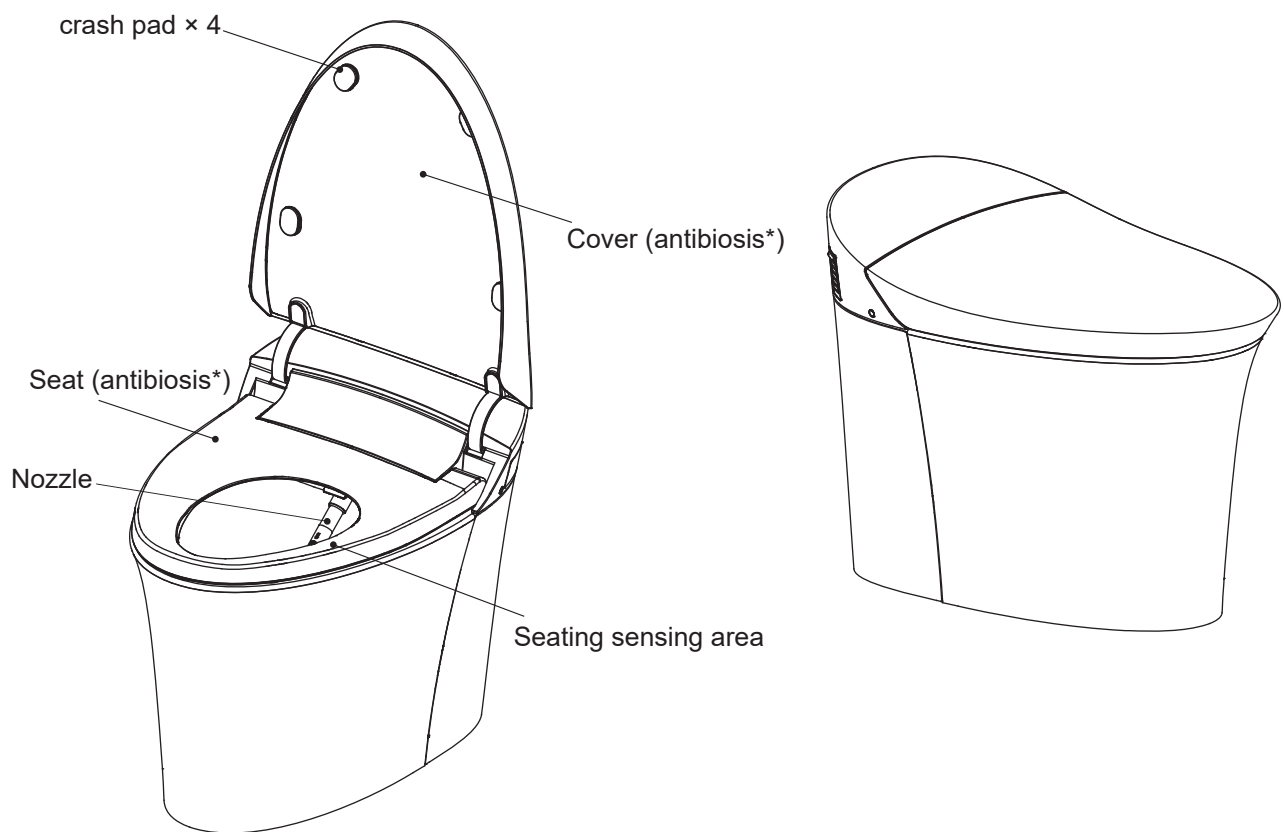

* Antibacterial: the seat and cover contains long term inorganic anti-bacteria material which will inhibit bacteria growth on surface, this does not represent the mildew and other incidental effects. The antibacterial rate is more than 90%. (Perform test in accordance with GB21551.2-2010 requirements. Testing lab: China household electrical appliances testing institute; electromechanical products testing technology center of Shanghai Entry-Exit inspection and quarantine bureau.)

Guide on usage of remote controller

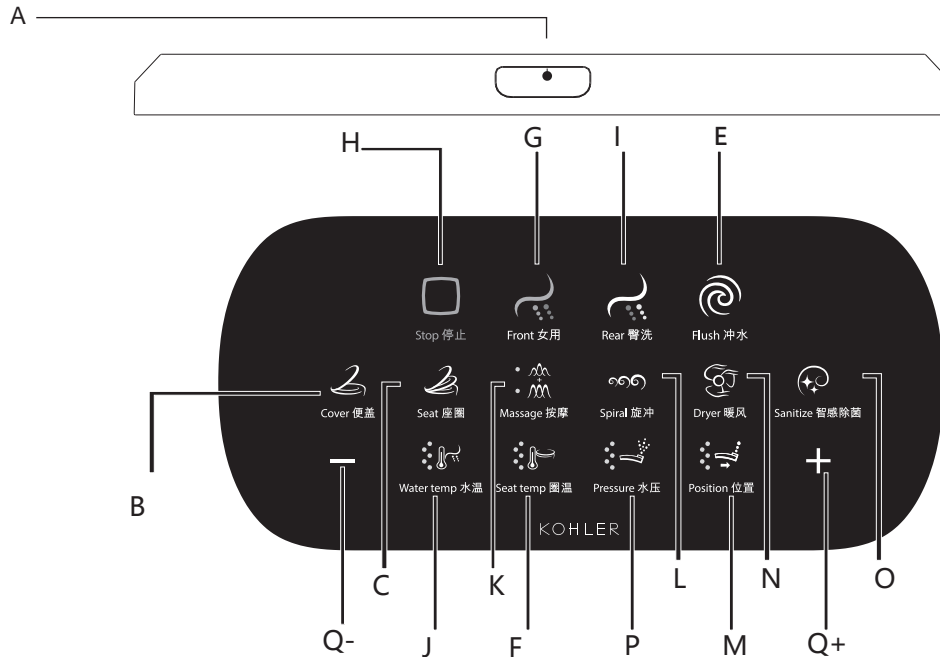

 **Warning:** Take down the remote control from charger before pressing Start key to prevent risk of falling.

A - Start

Press this key to turn on the remote control. Press it again to switch on/off after start. If the toilet is not connected after start, the icon in the third row will flicker. Connecting it successfully will stop it from flickering and enter into serviceable condition.

B - Open/close cover

Under non-seating status, press this key to open/close the cover.

C - Open/close seat

Under non-seating status, press this key to open/close the seat.

E - Flush

- Press this button to flush the toilet.

F - Seat temp

- Press this button to adjust temp dial, press +/- (Q+/Q-) to adjust seat temp.

G - Front

After seating, press this key to enter Front mode. After 5 minutes or so, the flush stops automatically or press the stop key to turn it off immediately.

H - Stop

- Press this key to stop the mode of Front, Rear, Dryer and Deodorization, Manual Cleaning Effuser or UV.
- Pressing this key for a long time will turn off the remote control.

I - Rear

After sitting, press this key to enter Rear mode. After 5 minutes or so, the flush stops automatically or press the stop key to turn it off immediately.

The Bidet is equipped with wide oscillate function. If you want to use wide oscillate function, please hold both REAR+POWER buttons for 2s on side panel, then activate rear wash oscillate mode.

J - Water temp

- Press +/- (Q+/Q-) to adjust water temp when front wash or rear wash is activated.

K - Massage

Under Front or Rear mode, press this key to enter the mode of mobile flushing. Press it again to enter the mode of impulse flushing. Press it at a third time, and the mode of mobile/impulse flushing will be activated at the same time. Press it at a fourth time to exit (When corresponding functions are activated, the light at the left side of icon will turn on).

L - Spiral

During the operation under Rear mode, press this key to flush water in a spiral shape. The icon of Spiral mode flickers. Press it again to exit (or press "Stop" to turn it off). The icon of Spiral mode will then stop flickering.

M - Position

- Press +/- (Q+/Q-) to adjust wand position when front or rear wash is activated.

N - Dryer

After sitting, Press this button to activate dryer function after seated, After 4 minutes or so, it stops automatically or press the Stop key to turn it off immediately.

O - Sanitize

During non-seating status, short press this key to enter UV sterilization function. And the icon will flicker.

P- Water pressure

- Under Front or Rear mode, press+/- (Q+/Q-) to adjust gears of water pressure.

O - Parameter adjustment key Q+/Q-:

Only J/F/P/M function is activated, the "+/-"key shall be used to adjust related parameter.



Low voltage alarm

Caution: Please charge in time when the voltage alarm is activated.

- When the  button flickers, it indicates that the built-in battery in the remote control is used up. Put the controller on the base to charge its battery;

Pairing

Caution: Pairing can be done only under unseated status.

- When the cover is powered on normally, press the Start key at the top of the remote control. When the icon of the lowest row flickers for a long time, it means the remote control needs to be paired with the main unit.
- Press and hold the Dryer key. When the icon at the lowest row flickers, start the operation at the main unit end.
- Meanwhile press and hold the  key and  key at side keyboard. Do not release the key until hearing a short beep.
- Once the icon at the lowest row of remote control stops flickering, it means it has been paired successfully.

Communication between remote control and toilet

- If the remote control is moved away from the sensing area, the icon at the bottom row of remote control will flicker automatically (indicating a searching the signal for the toilet). When the remote is near to the toilet, the signal will be connected automatically under normal power condition. Then the icon will stop flickering when it is connected successfully.

Poweroff function

- Press and hold the  key at any time, the remote controller will enter Power off mode.

Remote Setup Guideline

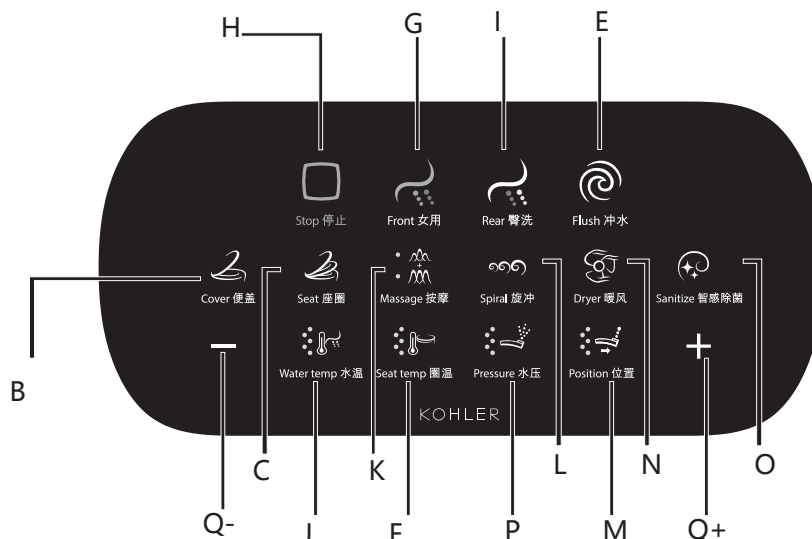

Keep pressing the  key until a short beep is heard, and release the key only after the night lamp flickers for three times. Then change the setting of B/C/E/F/I/O by the following requirements.

B - Open/close the cover...Sensing distance setting

- Press and hold the key to set up the sensing distance for auto cover-turning:

1. Night light quick flickers once means short distance (short beep).
2. Night light quick flickers twice means mid distance (short beep).
3. Night light quick flickers three times means long distance (short beep).
4. Night light slow flickers once means turn off auto lid-turning function (long beep).

C - Seat On/Off...Deodorization function setting

- Press and hold this key to turn on/off the deodorization function.

1. Night light quick flickers once to turn on deodorizer function (short beep).
2. Night light slow flickers once to turn off deodorizer function (long beep).

E - Flush...Automatic flushing setting

- Press and hold this key to set up the function of automatic flushing.

1. Night light quick flicker once to turn on auto flush function without closing the cover (short beep).
2. Night light quick flicker twice to turn on auto flush function with closing the cover (short beep).
3. Night light slow flicker once to turn off auto flush function (long beep).

F - Seat temp...Energy saving setting

- Press and hold the key of Seat Temp to activate the function of energy saving. Press and hold it again to deactivate this function.

1. Night light quick flickers once to turn on auto sterilization function (short beep).
2. Night light slow flickers once to turn off auto sterilization function (long beep).

I - Rear Wash...automatic flushing with closing the cover delay time setting

- Press and hold the key of Rear Wash to set up the delay time for automatic flushing with closing the cover

1. Quick flashing of night light once, indicates short-level time delayed(short pip).
2. Quick flashing of night light twice, indicates medium-level time delayed(short pip).
3. Quick flashing of night light 3 times, indicates long-level time delayed(short pip).

O - Sanitize Setting

- Press and hold to set up the on/off status of automatic UV sterilization.

1. Night light quick flickers once to turn on auto UV function (short beep).
2. Night light slow flickers once to turn off auto UV function (long beep).

When the setting of B/C/E/F/I/O is not modified for a certain period, repeat the process that is to keep pressing the  key until a short pip is heard and release the key only after the night lamp flickers for three times before the next change of setting.

M - Position...Effuser cleaning settings

- Under non-seating status, press and hold this key to activate the function of manual cleaning. The nozzle can be cleaned manually. Press and hold it again or press Stop key to deactivate this function.

Usage and Replacement of Battery for Remote Controller

- Battery holder - of remote controller uses 4 AA alkaline batteries.
- When battery is low, the battery holder lamp will flicker in red indicating the batteries need to be replaced, indicate the replacement of battery.
- Caution:
 1. The positive and negative polarities of battery must be consistent with the mark of remote controller.
 2. New and old batteries shall not be mixed.
 3. Please use alkaline battery.

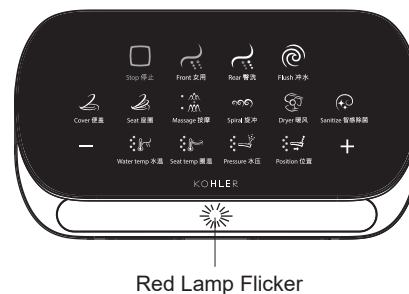

Red Lamp Flicker

Others

- Do not put the remote control at a place where it may be sprayed by liquid, or immersed in liquid.
- Do not place it near hand dryer, hair dryer and small size home appliances, to avoid disturbance of normal usage of the remote control.
- Do not apply external force to the key zone of remote controller frequently or fiercely.
- After usage of remote control, put it back into the remote holder mounted on wall.
- Prevent dropping the remote control during usage.
- Anti-loss function: lock remote on docking station by screws. Specific method refers to installation instruction.

Preparations before the initial use

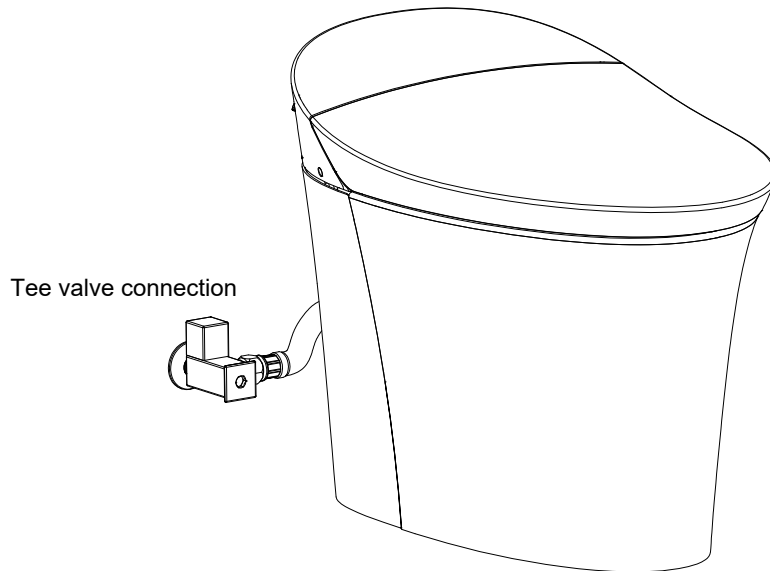

- Ensure if water inlet valve is OPEN.
- Confirm that the battery has been correctly installed in the "remote controller".
- Confirm that there is no obstacle in front of the product.
- the toilet complete the self check, after the product is powered on. During that time, it is normal to hear rotating sound of the motor and bicker, or see the night light flicker. When the lighting stops flickering, the self-check is completed.
- When used for the first time, it will be in a default state:
 - Front:
 - Water temp: mid
 - Water flow intensity: mid
 - Position: dial 3
 - Rear:
 - Water temp: mid
 - Water flow intensity: mid
 - Position: dial 3
 - Spiral:
 - Water temp: mid
 - Water flow intensity: mid
 - Position: dial 3
 - Seat temp: mid
 - Night light: On
 - Energy saving mode: On
 - Auto Lid Turning Function: On; distance, mid
 - Auto Flush Function: Automatic flushing without closing the cover
 - Sanitize Function: On
 - Electrolyzed water Function: On
 - Deodorizer: On
 - Water pump: On (press and hold flush and front wash button on toilet side panel, short "beep" indicates water pump is on, long "beep" indicates water pump is off.)

Function for opening/closing of cover/seat

A Open/close cover

- Auto cover opening/closing

When cover is CLOSE, user enters sensor area, cover auto open.

When cover is OPEN, user leave sensor area, cover auto close after a period of time.

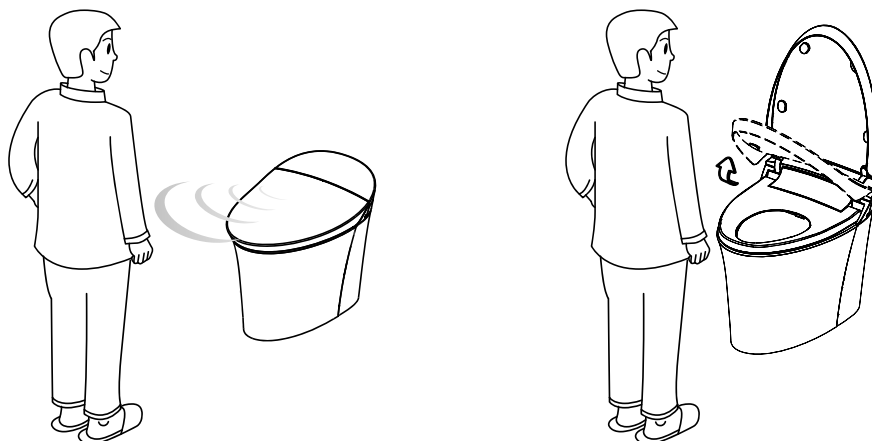

- Lid open/close by remote

Under unseated status, press Cover Open/Close key on the remote controller to execute corresponding opening and closing function (details are shown in the diagram of the remote control). Under seating status, the  key of remote control will not respond.

- Manual cover opening/closing

Users can open or close the cover directly by hands. When users intend to open or close the cover under normal condition, the cover can open or close automatically against the trend of motion.

Users will not have to use force. Once being stopped by any obstacle during motion, the cover will automatically stop moving.

NOTES:

1. When the user walk by the sensing area slowly, the sensing distance for cover opening/closing may be shortened. If no response is made, please open or close the cover with the remote control or by hands.
2. The function of auto cover opening/closing works only when "setting of lid opening/closing" in remote controller is "On" (Refer to page 9 for setup method)
3. Do not place any movable obstacle within 40cm in front of toilet. If any, the cover will open automatically; if you would like to deactivate the function of "auto lid open/close", please refer to page 9.

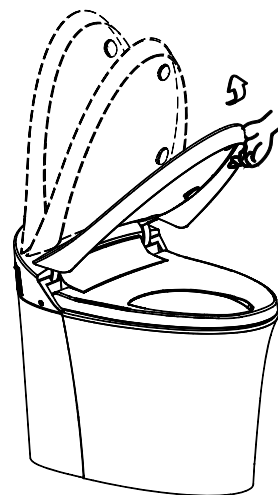

B Open/close seat

- Cover opening/closing by remote controller

Under unseated status, press Seat Open/Close key on the remote controller to execute corresponding opening and closing function (details are shown in the diagram of the remote control). Under seating status, the  key of remote control will not respond.

• Manual seat turning

Users can open or close the seat directly by hands. When user intends to open or close the seat under normal condition, the seat will open or close automatically against the trend of motion. User will not need to use force. Once being stopped by any obstacle during motion, the seat will stop moving automatically.

Notes:

During automatic open/close of cover and seat, do not use excessive force when opening/closing the cover seat.

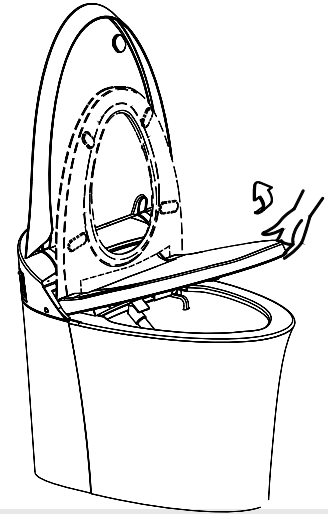

Flushing of toilet

A. Auto-flushing function

a) Usage of seat

When seat is OPEN and toilet is in use. Toilet will auto flush after unseated for a certain time. Close seat within a period of time.

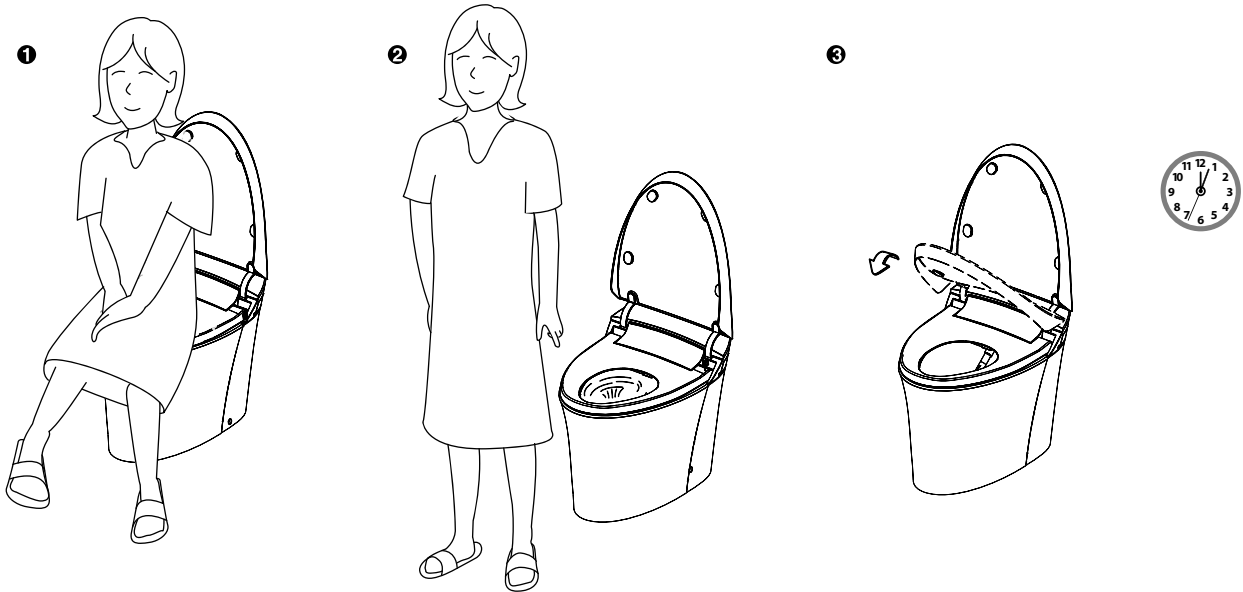

b) Man use

When seat is OPEN, open seat manually or by remote; Toilet will auto flush after unseated for a certain time. Auto close seat/cover after a period of time.

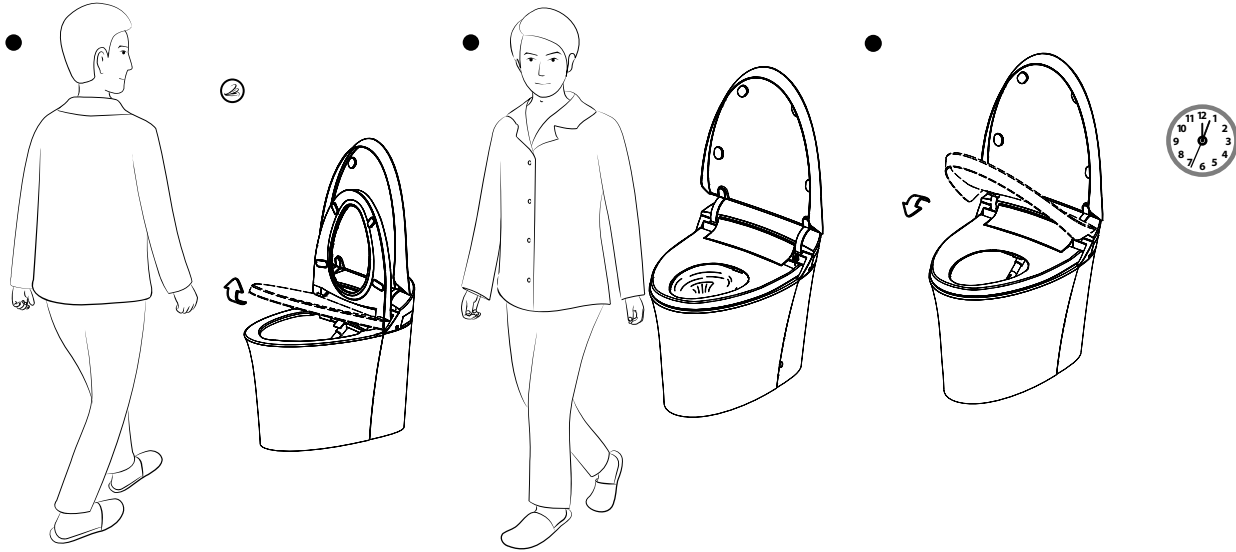

Notes:

1. If the automatic flushing function is deactivated, user can control flushing by pushing manual buttons, using the remote control, or a basin.
2. The function of auto flushing works only when “flushing setup” in remote controller is “On” (Refer to page 9 for setup method).

B. Flushing with the remote control

Press flush button on remote to enter flush function.

Notes: The action of flush will not be done twice until the flushing with the remote controller finishes.

C. Emergency flush

When power is off, please press and hold flush button on toilet side panel to activate emergency flush function.

Notes: The power source of this function is supplied by the built-in alkaline battery.

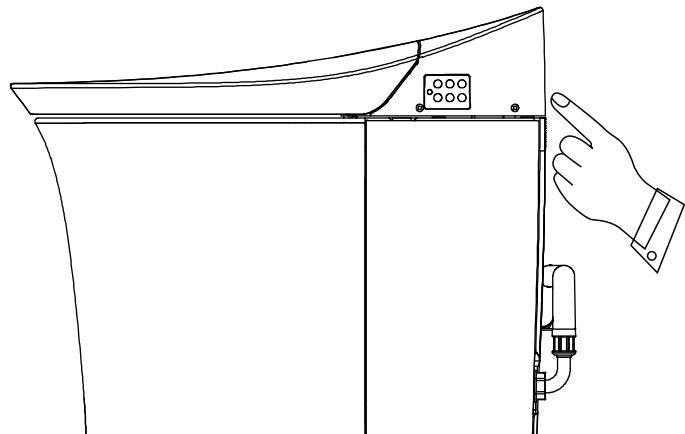
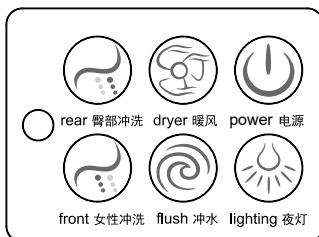

D.Manual flushing by basin

When emergency flush key is invalid, the cover and the seat will open, flush away the sewage by using a container of water.

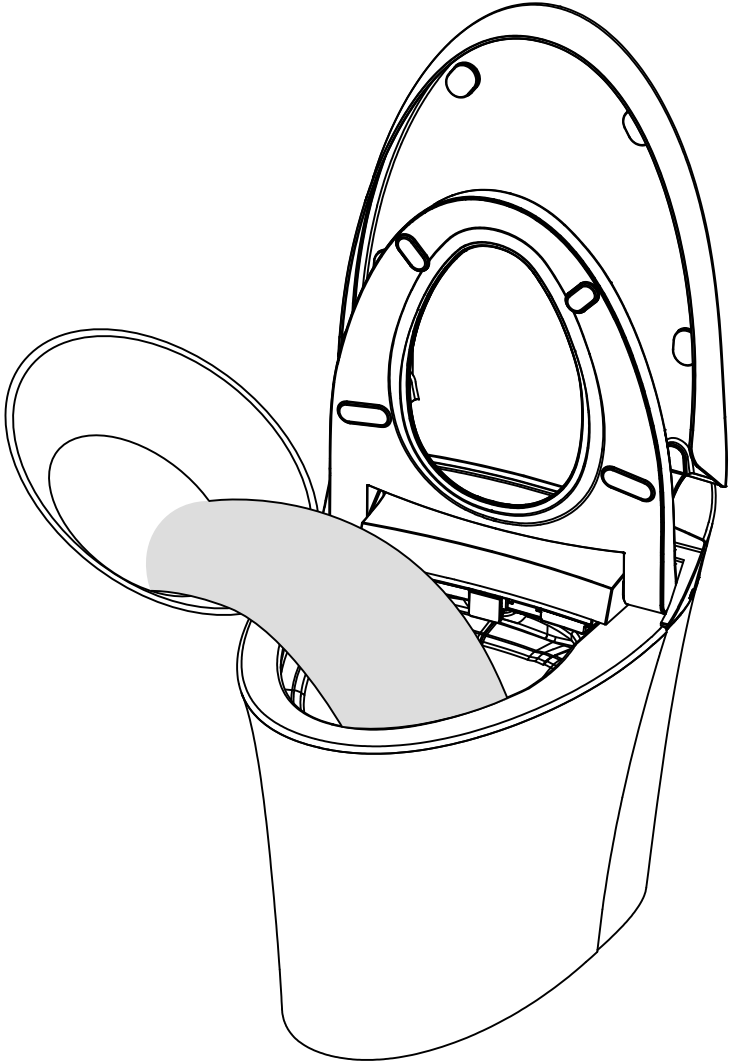

Auxiliary keyboard function

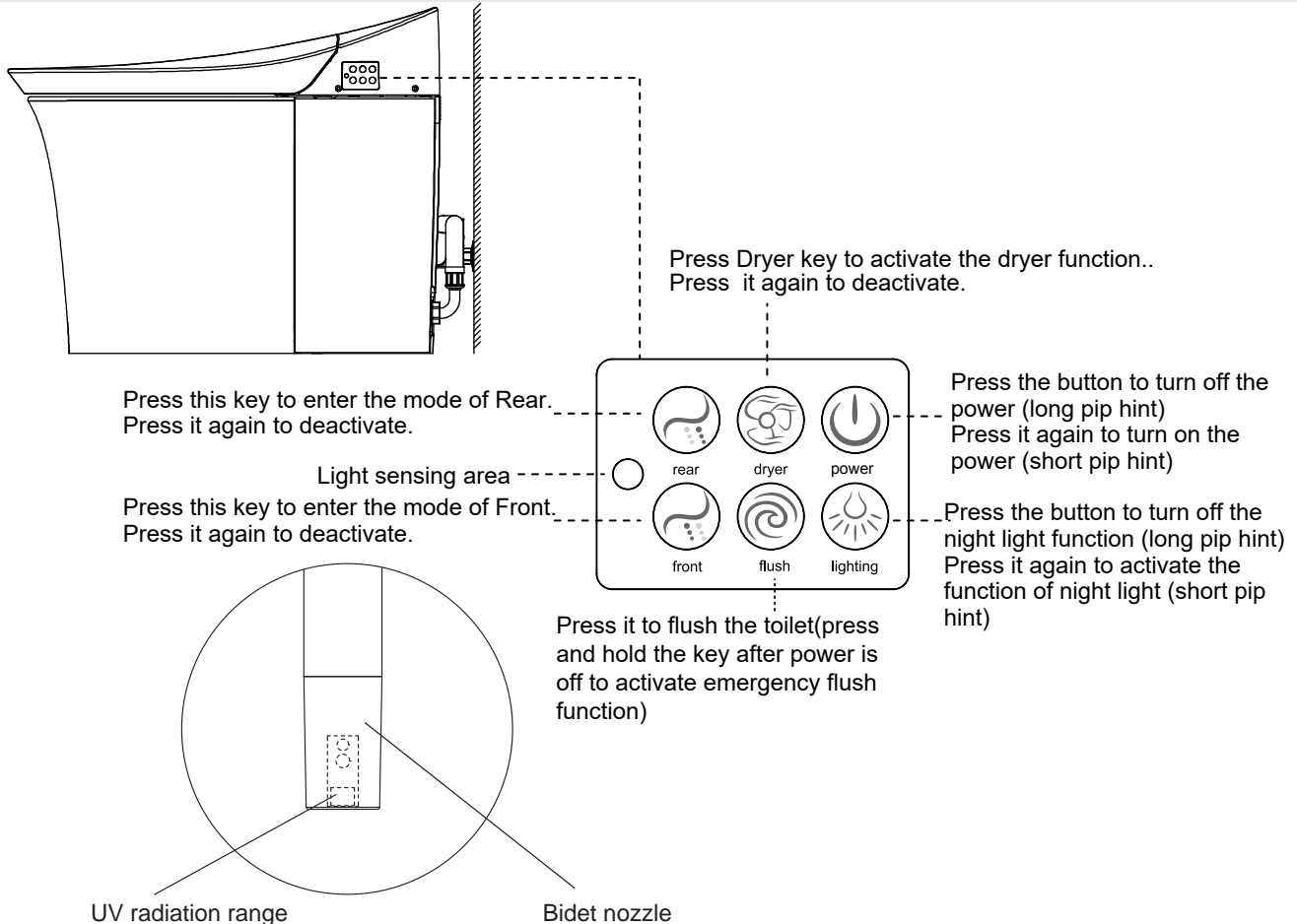

Notes:

1. Each function shall operate per factory setting.
2. Under the mode of Front or Rear wash, press it again to deactivate this function. Otherwise, it will stop automatically after 5 minutes.
3. Under the Dryer mode, press it again to deactivate this function. Otherwise, it will stop automatically after 4 minutes.

Standby mode

1. Press POWER button on side panel, enter standby mode when generate one "beep". Meanwhile, auto detection and remote function OFF, seat heating function deactivated to minimize energy consumption.
2. When press POWER button on side panel again, exit standby mode and all function recovered.

Sanitize function*

- Sanitize function is achieved by UV sterilization on wand.
- Automatic UV sterilization
 - If the product is not used for a long time, the function of UV sterilization will be activated automatically. By this way, the effuser will then be sterilized. The function will not be activated again for another 24 hours.
 - If during UV sterilization a user is sitting on the seat, or the stop key on the remote control is pressed, UV sterilization deactivate.
 - For setting of automatic UV function, see page 9.
- Manual UV sterilization
 - If unseated, short press the UV key on remote control to execute the function of UV sterilization immediately.
 - If during UV sterilization a user is sitting on the seat, or the stop key on the remote control is pressed, UV sterilization deactivate.

* UV sterilization (refers to the ultraviolet sterilization generated by UV lamp): During UV working cycle, the bacteria on nozzle surface will be eliminated by irradiation. The antibacterial rate is more than 99%. (Measured after one UV working cycle, it was measured within 18mm×8mm irradiation area. Perform test in accordance with GB/T 23131 requirements, UV radiation zone was shown in the diagram, UV working cycle activation mode refers to users guide. Testing lab: China household electrical appliances testing institute.)

Sterilized water*

- The function of sterilized water is to disinfect the wand.
- After customer uses front wash, rear wash or spiral wash function, the toilet will activate sterilized water function after customer leaves toilet.
- When the toilet is out of use, sterilization will be activated once every 8 hours.

* Sterilized water (refers to refers to the tap water containing hypochlorite generated by chlorine ions after ionization): Sterilized water generated during electrolysis working cycle eliminates bacteria on the nozzle surface. The antibacterial rate is more than 96%. (Perform test in accordance with GB /T 23131 when the content of chlorine ions in tap water is >24ppm. Different water quality might cause different sterilization effect. Electrolysis working cycle activation method refers to operation description. Testing lab: China household electrical appliances testing institute.).

Automatic energy saving function

- When energy saving set to ON status, product shall auto detect the idle hours and decrease the heating temperature to reach of energy saving purpose.
- For details of automatic energy saving, refer to pages 9.

Maintenance and cleaning

A. Normal cleaning

For the best effect, remember the following rules during maintenance of your Kohler product:

Important! Do not flush the cover directly by water (including remote controller)

- FiTesting - apply cleaning solution at an inconspicuous place on lid for testing. Make sure the cleaning solution will not damage the outer surface of cover, and then apply it to the entire surface.
- Do not immerse in cleaning solution. Do not immerse the product in cleaning solution.
- Avoid using materials that will damage the surface-Clean the surface with a soft and wet sponge or cotton cloth, instead of materials that can damage the surface.
- Scrubbing - After adding the cleaner, use a wet towel to scrub the surface immediately to remove cleaner or dirt sprayed to the surface.

Cleaning the seat

- Do not use abrasive cleanser or sanitizer inside the spray tank for cleaning.

Maintenance: In case of using a mixture of washing agent and water as well as any available solution for seat cleaning, use soft and wet sponge or towel to clean the seat. Use a soft towel to make the seat dry, or let it dry naturally.

- Corrosive chemicals or cosmetics (such as nail polish or aftershave) should not come in contact with the seat as this will damage the surface.

Clean stainless steel beauty parts

- Clean surface with neutral soap water, and then wipe the whole surface off with clean and soft rag. Do not use cleaners, such as Ammonia, decontamination powder or toilet cleaner which will cause surface damage.

Caution: Failure to follow cleaning instructions may invalidate the warranty of Kohler.

Caution: The success of the cleaning process depends on the water hardness and temperature, the dose precision of composition, cleaning regulation variation and cleaning product status etc. factors. Kohler can't ensure the validity of rules since these factors may change.

Caution: When clean the opening lid, brute force applied to the lid will damage the product.

Clean hinge arm

Wipe the hinge arm by a soft cloth on a regular basis to prevent from sticking to the hinge arm, and to reduce the brightness of the hinge.

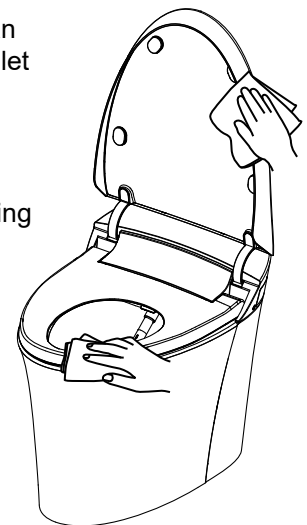

B. Nozzle clean

Method of washing the front/rear wash nozzle with a soft brush:

- Under unseated status, push and hold the “Position” key on the “remote control” for 2 seconds, or press and hold the front wash or rear wash key on the side panel to extend the nozzle.
- Use a wet soft brush to clean the nozzle.
- Press one of the above keys or the stop key on remote control one more time. The nozzle will retract or the nozzle will retract automatically after 2 min.

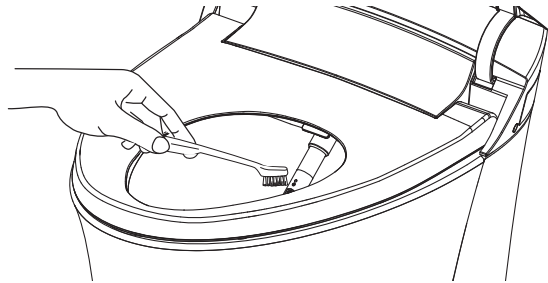

Customer to remove nozzle for cleaning:

- When unseated, push and hold the “oscillate” button on the “remote control” for 2 seconds, or press and hold the front wash or rear wash button on the side panel to extend the nozzle.
- Disconnect power supply within 2mins.
- Remove nozzle along the arrow direction as shown.

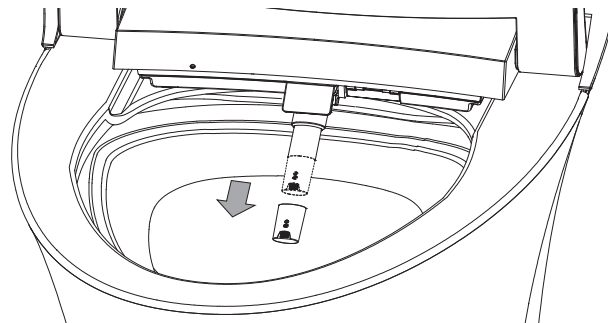

- Immerse nozzle into cleaning solution for 2 hours.
- Clean with soft brush.

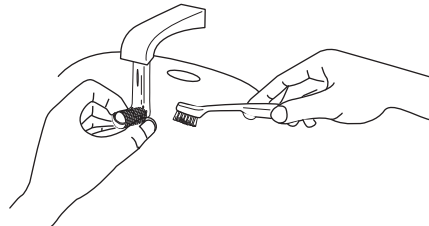

- Mount nozzle back to original position along the dismantle direction.
- Check nozzle clean function after power is ON.

C. Cleaning or replacing the filter

Clean or replace the filter if there's not enough water volume or water is not coming out.

Cleaning the toilet filter

- Disconnect the power, turn off tee valve and remove the filter plug.

1

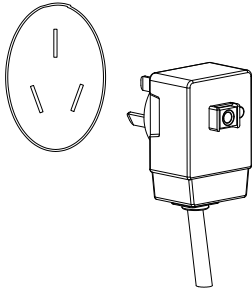

Disconnect the power

2

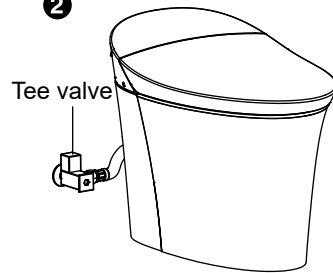

Turn off water valve

3

Remove side plate

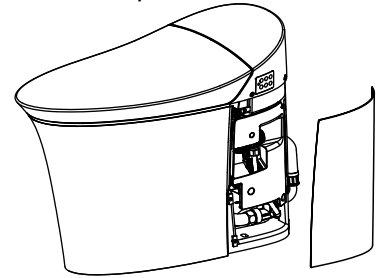

- Take out filter and clean it

4

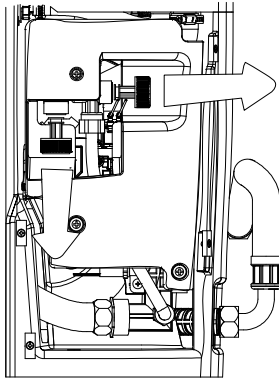

5

Clean filter

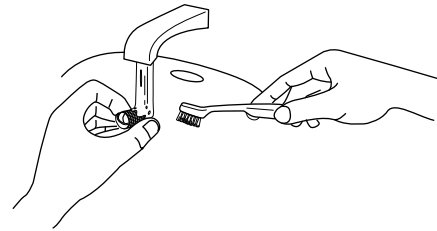

- Reinstall the filter, attach the hose connector and turn on the tee valve.
- Check that the connection does not have any water leakages before connecting the power.
- Set the side plate to its original position.

Cleaning of tee valve filter

- 1 Disconnect the power plug
- 2 Turn off tee valve, and remove filter cover
- 3 Remove filter
- 4 Clean filter

The steps to replace filter are the same as the above steps.

Notes:

If the filter is found to be damaged or severely clogged, please replace it in a timely manner, The mesh size of the filter shall not be less than 80 mesh.

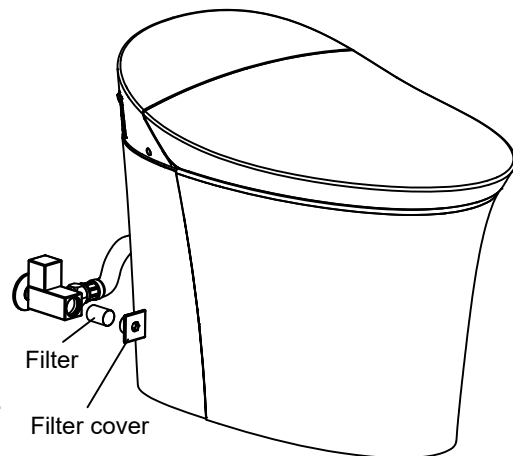

D.Replacement of deodorization block

If users find the effect of deodorization is unobvious and feel any peculiar smell, please replace deodorization block in time.

Steps to replace deodorization block:

- Remove deodorization-door and deodorization block

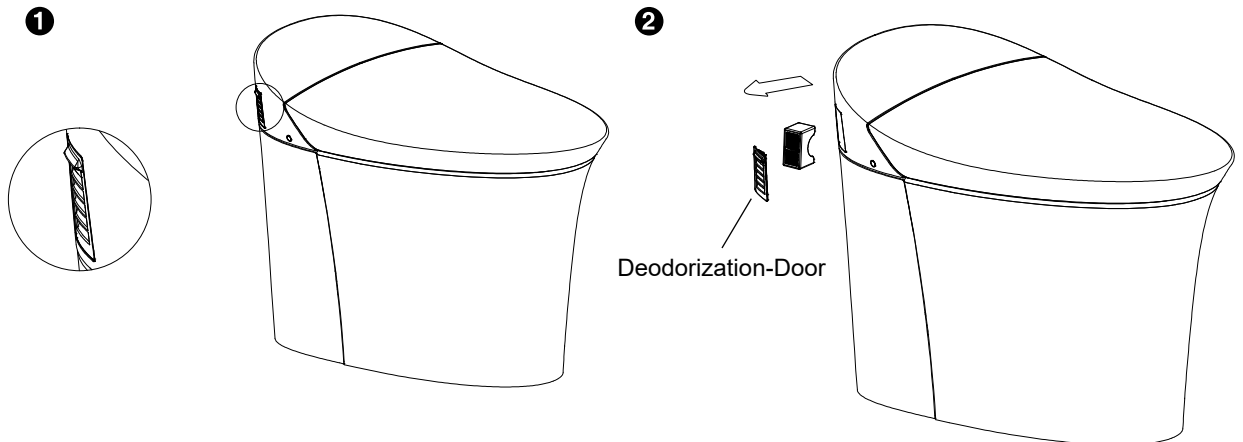

- After replacing the deodorization block, put it back into the toilet.

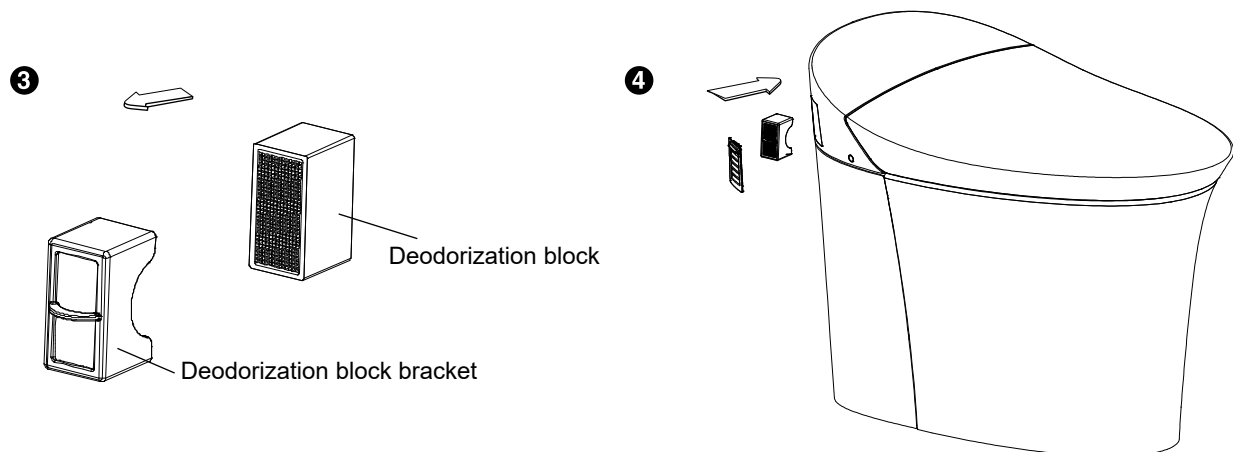

Notes:

After removing the deodorization block, do not put your hands or other substances into holding cavity of deodorization block as doing so will damage the fan and other parts.



Scan the QR code to order the replaced part with the part number 22761T-NA.

E. Maintenance in case of long-term idle status

a) If the intelligent toilet will be idle for a long term, make sure the water in pipeline of cover is drained completely:

- Disconnect the power plug, and turn off the tee valve. Press the release button of heating pipe, exhaust the water inside heating pipe with a small and long rod.

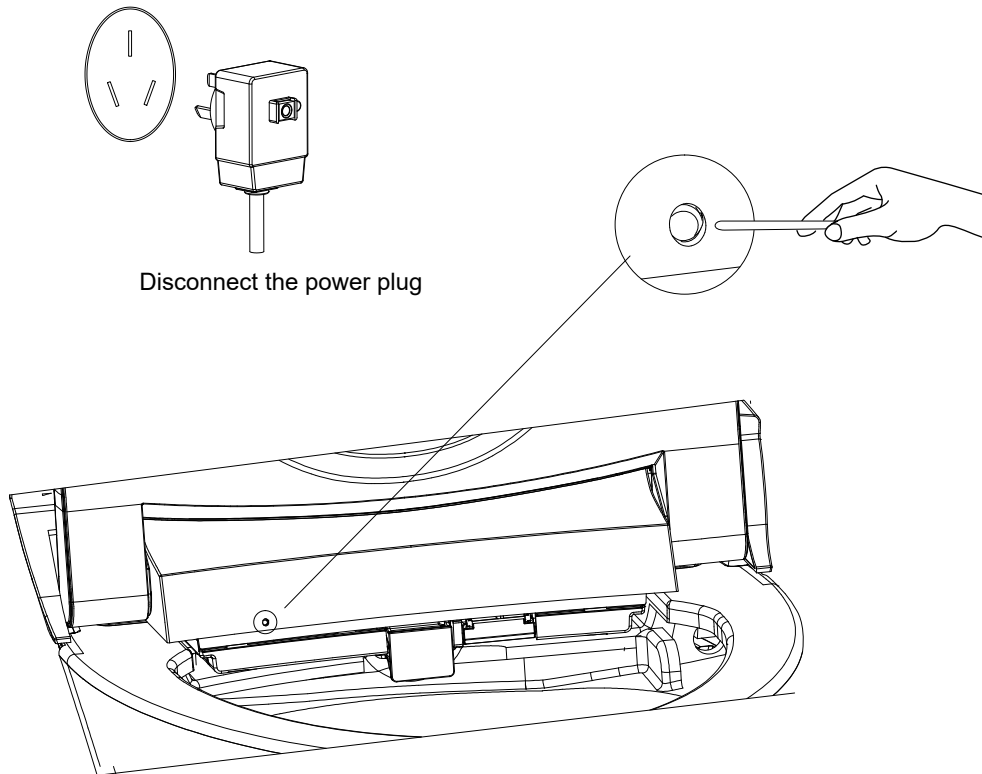

Notes:

1. If water is not completely drained and meanwhile the product is idle for a long time, the residual water may freeze in Winter or go bad in Summer.
 2. If you find the water supply pipe has been frozen, do not use the intelligent cover. You will need to raise the room temperature and use it after the water is thawed.
 3. When the temperature in Winter exceeds the normal working temperature, and there is a risk of freezing in water pipe, please turn off the tee valve and perform one flush to the toilet.
 4. Before use after long term idle condition, please close the tee valve and then press it again for flushing.
 5. Before use after long term idle condition, make sure to wash it for several times and the inner pipelines are clean.
 6. In case of long term idle status, remove the batteries in the charging block of remote control.
- b) Open cover or add water inside the toilet might avoid the plastic parts yellowing problem caused by backflow air from discharge pipe after residual toilet water evaporated during long-term idle status.

Trouble shooting

This guide of trouble shooting is for general help only. Authorised representatives or qualified electricians of Kohler Company shall be able to solve all electrical failures. If you want to know about the service of warranty, please contact local dealers or wholesalers.

Troubles	Possible reasons	Suggestions and measures
1. Toilet does not work	<ul style="list-style-type: none"> A. Power failure B. Plug not connected or no power to socket C. The leakage circuit breaker at cable plug can not reset D. Product is at standby mode 	<ul style="list-style-type: none"> A. Wait until the power is restored B. Insert the plug or detect the power socket C. Press Reset button on the plug D. Press Power button at the side. Wake up the product
2. Toilet can not flush	<ul style="list-style-type: none"> A. Water failure B. Tee valve for water supply is closed C. Power failure D. Product is at standby mode E. Wash mode is in progress F. Auto-flushing is deactivated 	<ul style="list-style-type: none"> A. Wait until the water supply is restored B. Open the tee valve for water supply C. Wait until the power is restored or hold and press auxiliary flush button on toilet side panel, or flush by using the basin. D. Press Power button on the side to wake up the product E. Do it after the operation at wash mode is completed F. Refer to "Guide on setting of remote controller"
3. Emergency flush is not working	<ul style="list-style-type: none"> A. Spare battery pack is low 	<ul style="list-style-type: none"> A. Contact Kohler service department to replace battery pack
4. Toilet is not clean after flushing	<ul style="list-style-type: none"> A. Filter screen is blocked B. Water pressure is insufficient C. Water pump is not working 	<ul style="list-style-type: none"> A. Refer to "Washing of filter screen" B. Check if all tee valves are opened. If not, please open; Check if the inlet hoses are bent. If so, adjust the hoses. C. Reload power. Contact Kohler service department if such problem occurred again
5. Wash mode is abnormal	<ul style="list-style-type: none"> A. Water failure B. Tee valve for water supply is closed or not opened completely C. Product is at standby mode D. Not yet seated or current sitting posture unable to be sensed by the seat E. Filter screen is blocked F. Water pressure is insufficient G. The toilet is in the process of flushing 	<ul style="list-style-type: none"> A. Wait until the water supply is restored B. Fully open the tee valve for water supply C. Press Power button at the side to wake up the product D. Sit on or adjust your sitting posture E. Refer to the section of "Washing the filter screen" F. Check if the inlet hoses are bent. If so, adjust the hoses. G. Flush again after this flushing is completed.
6. Flushing mode stops in the operation process	<ul style="list-style-type: none"> A. Flushing mode stops automatically after continuous flushing for 5 minutes B. The seat is unable to sense human body 	<ul style="list-style-type: none"> A. If necessary, press the flushing button again. B. Adjust your sitting posture or sit on the toilet again.
7. The wash mode runs even when no one is sitting on the toilet.	<ul style="list-style-type: none"> A. The seat is covered by foreign matters or the seat is wet 	<ul style="list-style-type: none"> A. Remove the foreign matters or dry the seat
8. Dryer fan stops in the operation process	<ul style="list-style-type: none"> A. The dryer fan stops automatically after continuous usage for 4 minutes B. The seat is unable to sense human body 	<ul style="list-style-type: none"> A. If necessary, press the Dryer button again B. Adjust your sitting posture or sit on the toilet again.

9. Deodorization fan not work	A. The seat is unable to sense human body B. Stop button is pressed by mistake during operation C. Auto deodorization function is deactivated	A. Adjust your sitting posture or sit on the toilet again. B. If necessary, please leave for about 2S and then sit on the toilet again. C. Refer to "Guide on setting of remote controller"
10. Cover fails to close/open	A. The seat is covered by foreign matters or the seat is wet B. The toilet cover is interfered by people at the open/close process before	A. Remove the foreign matters or dry the seat B. Use the remote control to open/close the toilet cover or do it manually until it works normally. The cover switch should not be stopped during the open/close process
11. Cover unable to open/close automatically	A. Users are not seated yet or left the sensing area B. The function of "automatic cover-turning" of remote controller is deactivated C. The toilet is in the process of flushing	A. Please sit or leave the sensing area B. Refer to "Guide on setting of remote controller" C. Wait until the flushing process is completed
12. Night light does not work	A. The night function is turned off B. The indoor light is too bright	A. Check the section of night light at "auxiliary keyboard function" to activate the night function B. Please turn off the indoor light and close the curtain
13. Sanitize function is not working.	A. User does not enter or leave sensing zone. B. The seat is covered by foreign matters or the seat is wet	A. Reactivate Sanitize function after unseated. B. Remove the foreign matters or dry the seat
14. Remote failures	A. Out of battery B. Battery polarities are mounted reversely C. The remote controller is not woken up	A. Replace with new batteries B. Reinstall properly C. Touch the screen of the remote control Sit near the toilet or on it Press Wake up key on the remote control
15. Remote control fails to control the toilet	A. Lower battery B. The remote control is too far from the toilet C. The toilet is not yet powered on D. The toilet itself is on standby mode E. The toilet is not connected to the remote control	A. Replace battery by referring to the section of "Usage and replacement of battery for remote control" B. Check the section of "Communication between remote controller and this machine", and get close to the toilet C. Power on the toilet D. Press Power button at the side to wake up the product E. Check the section of "Communication between remote control and this machine", and connect the toilet and the remote control

If this toilet is to be repaired and maintained, you have to:

Disconnect the power plug of toilet

If necessary, turn on the water valve.

Description of Content of Hazardous Substances in Product

Reclaim Indication

When the product exceeds service life or is unable to use after repair, do not throw the product away in the normal trash. Please dispose the waste electronic parts through a qualified reclamation enterprise. Make sure the product is handled properly. Disposing of product must be done in accordance with the local or national government law.

Statistics of Contents of Toxic or Hazardous Substances or Elements

Part name	Toxic or Hazardous Substance or Elements					
	Lead (Pb)	Mercury (Hg)	Cadmium (Cd)	Hexavalent Chromium (Cr(VI))	Polybrominated biphenyls (PBB)	Polybrominated Diphenyl Ethers (PBDE)
Plastic Assy.	○	○	○	○	○	○
Control Assy.	×	○	○	○	○	○
PCBA Assy.	×	○	○	○	○	○
Motor Assy.	×	○	○	○	○	○
Wire Harness Assy.	○	○	○	○	○	○
Water Inlet Assy.	○	○	○	○	○	○
Wand Assy.	○	○	○	○	○	○
Heater Assy.	×	○	○	○	○	○
* Remote Assy.	×	○	○	○	○	○
* Battery	○	○	○	○	○	○
* Ceramic Assy.	○	○	○	○	○	○
* Water Tank Assy.	○	○	○	○	○	○

This form is prepared in accordance with SJ/T 11364.

○: Indicates that the substance in the material composition is below the high limits of the current requirements in GB/T 26572.

×: Indicates that at least one of the homogeneous substance in the material composition is below the high limits of the current requirements in GB/T 26572.

*: Indicate only partial product series contains this substance.

Note: the information provided is based on the supplier data and Kohler inspection results. The product is designed not to hurt the environment. Under current technology, all hazardous materials have been used in the smallest amounts possible. Kohler will strive to reduce the use of these hazardous materials used in this product.



The product “service life for environment protection” is 10 years; Kohler Company will specify product service life based on product characteristics. The product “service life for environment protection” is only effective when the product is used as described in the product specification.

目录

安全注意事项.....	25
规格	27
感谢您选择科勒公司.....	28
整机简图.....	28
遥控器使用指南.....	29
遥控器设置指南.....	30
初次使用前准备.....	32
开、关盖/开、关圈	33
便器冲水.....	34
辅助键盘功能.....	37
待机模式.....	37
智感除菌功能	37
除菌水功能.....	38
自动节能功能.....	38
维护清洗.....	38
常见问题.....	43
产品中有害物质含量的说明.....	45

安全注意事项

保存这些说明



警告：触电、火灾或人身伤害的危险。本产品必须安全接地。只能连接到专用的220V~，50Hz，10A带接地故障断路器或接地漏电保护器的电路中。



警告：触电或产品损伤的危险。不要把产品浸入水中。



警告：在安装本坐便器时切勿使用任何凝胶材料（水泥砂浆）。因为凝胶材料（水泥砂浆）的热膨胀可能使坐便器的脚部挤破或损坏。科勒对所有因为凝胶材料（水泥砂浆）安装而引起的坐便器破裂恕不负责。



警告：提防损坏产品。请不要向便器内冲入新闻纸、纸尿裤、妇用卫生巾等容易堵塞的物品。请不要用重力撞击陶瓷，以防止破损漏水。不要在0°C以下的环境中使用。

重要！产品损伤的危险。不要安装在水可能溅到的地方。

重要！产品损伤的危险。不要把产品安装在过分潮湿的地方，在这种地方，水汽可能凝聚在产品表面。请始终保持使用环境有足够的通风，以防止电子组件的损坏。

重要！产品损坏或财产损失的危险。硬推、硬拉水管接头可能造成水渗漏。

重要！产品损坏的危险。不要在喷嘴上施加过大的力，否则产品可能损坏。

重要！产品损坏的危险。在一些水可能在水管中结冰的地方，要做好水管保温的安排。任何留在产品里的水在冬天储存时都可能结冰。在重新安装或使用前请保证产品暖至室温。

重要！产品损坏的危险。在安装工作完成之前不要接通电源，这可能导致产品故障。

注意：温暖的气候时，热保护器在存储或运输过程中可能失灵，导致产品不工作。在重新安装或使用前请保证产品冷至室温。

当使用电器产品时，尤其当儿童在场时，应该遵守基本的安全防范，包括如下：

危险—降低触电的危险：

- 不要把此产品放置在可能掉落或可能被拉入浴缸及水槽的地方。
- 不要放置或掉到水及其他液体中。
- 不要触及掉进水中的产品，请立刻拔掉电源插头。

警告—避免低温灼伤、触电、火灾或人身损伤

- 当儿童、老年人、残疾人，以及身体、感知、智力能力缺陷或经验和常识缺乏的人使用或靠近此产品时，近距离的监护是必需的。儿童不应该被允许使用或接触此产品，不要让儿童独自呆在安装有此产品的房间，儿童不应玩耍器具。
- 对于无法自己进行温度调节操作的儿童和老人，需要帮助将坐便盖的圈温、冲水温度及风温调节到合适的档位

安全注意事项（续）

- 仅按照手册中所描述的方式使用本产品，不要使用科勒不推荐的附件，如角阀等。
- 使用时请勿倚靠在盖板上，以免损坏产品。
- 如果有以下情况请不要使用本产品：电源线、插头及产品有损坏；产品不能正常工作；产品掉入水中。
- 根据安装说明正确地安装本产品。
- 只有专业人士可以修理此产品。不要试图自己维修此产品，否则保修无效。
- 在安装本产品的同一房间中，需要在触手可及的位置安装一个止水阀，用于紧急情况下，无需借助工具即可切断本产品的进水水路；否则本产品的意外故障可能会导致用户损失。
- 使电源线远离加热表面。
- 不要把任何物品掉入或插入管路和开孔处。
- 不要在户外或者微粒喷雾设备正在被使用的地方使用本产品。也不要给在给氧的地方使用本产品。
- 在通电之前必须按照说明书中的要求接地。
- 防止将水淋到电源插头上。
- 请避免长时间让裸露的皮肤接触加热座圈，以免低温灼伤。
- 如果电源线损坏，为了避免危险，必须由制造商、其维修部或类似部门的专业人员更换。
- 需要有资质的维修人员维修紫外线杀菌装置。
- 必须使用随器具附带的新软管组件，旧软管组件不能重复使用。
- 用户切断电源后，如须再次接通电源，请务必听到“滴，滴...”提示音结束后，再接通电源。

规格			
冲水用水量		4.0L	
水效等级*		2级	
使用坑距		305mm	
供水压力		最小进水压力0.07MPa（动压） 最大进水压力0.74MPa	
额定电压		220V~, 50Hz	
额定功率*		1090W	
电源线长度		约1.3m	
产品外型尺寸		约670mm x 438mm x 533mm	
产品重量		约48kg	
进水温度		1-35°C	
使用环境温度		1-40°C	
清洗	臀部冲洗		有，档位可调
	旋转冲洗		有，档位可调
	女性冲洗		有，档位可调
	出水流量（水压0.2MPa时）		臀部冲洗最大档不小于500mL/min
	清洗水温调节		关、五档可调（室温、约31-39°C）
	冲洗时间（最长）		约300s
	喷嘴位置调节		5档
	脉冲按摩		开/关
	移动冲洗		开/关
	安全装置		水温过热保护 温度保险丝
		逆流防止 单向阀	
舒适	座圈保温		温度调节 关、五档可调
			安全装置 温度保险丝
	盖板		自动开合、缓降、遥控开合
	座圈		缓降、遥控开合
	暖风		暖风功能 有
			安全装置 温度保险丝
	除臭功能		有
遥控器		功能设置见30-31页	
卫生	喷嘴自清洁		有
	抗菌材料		座圈、盖板
	除菌水		有
	UV除菌		有
其它功能	其它安全装置		漏电保护器
	辅助键盘		有
	落座感应		位于座圈内部
	夜灯		有
	自动开关盖		微波感应
	手动冲洗		有
	IOT功能		仅K-5401T-5XP-0

* 智能坐便器施加的水效标识的说明：水效标识表示智能坐便器水效等级等性能的一种符合性标志。

* 功率值测试条件：动压0.2MPa，进水温度15°C。

感谢您选择科勒公司

感谢您选择科勒。科勒技术提供了可靠性能和优雅生活的结合，满足了您未来几年的需求。科勒产品的美观和可靠性将满足您最挑剔的眼光。我们为我们科勒的产品感到非常地自豪，相信您也会。

请花几分钟阅读一下这本用户手册，特别注意维护和清洗说明。

这本说明书中所有的信息基于最新公开的产品信息。在科勒，我们一贯坚持改善我们产品的质量。我们保留在任何时候不通知的情况下改变产品特性，包装或实用性的权利。

整体简图

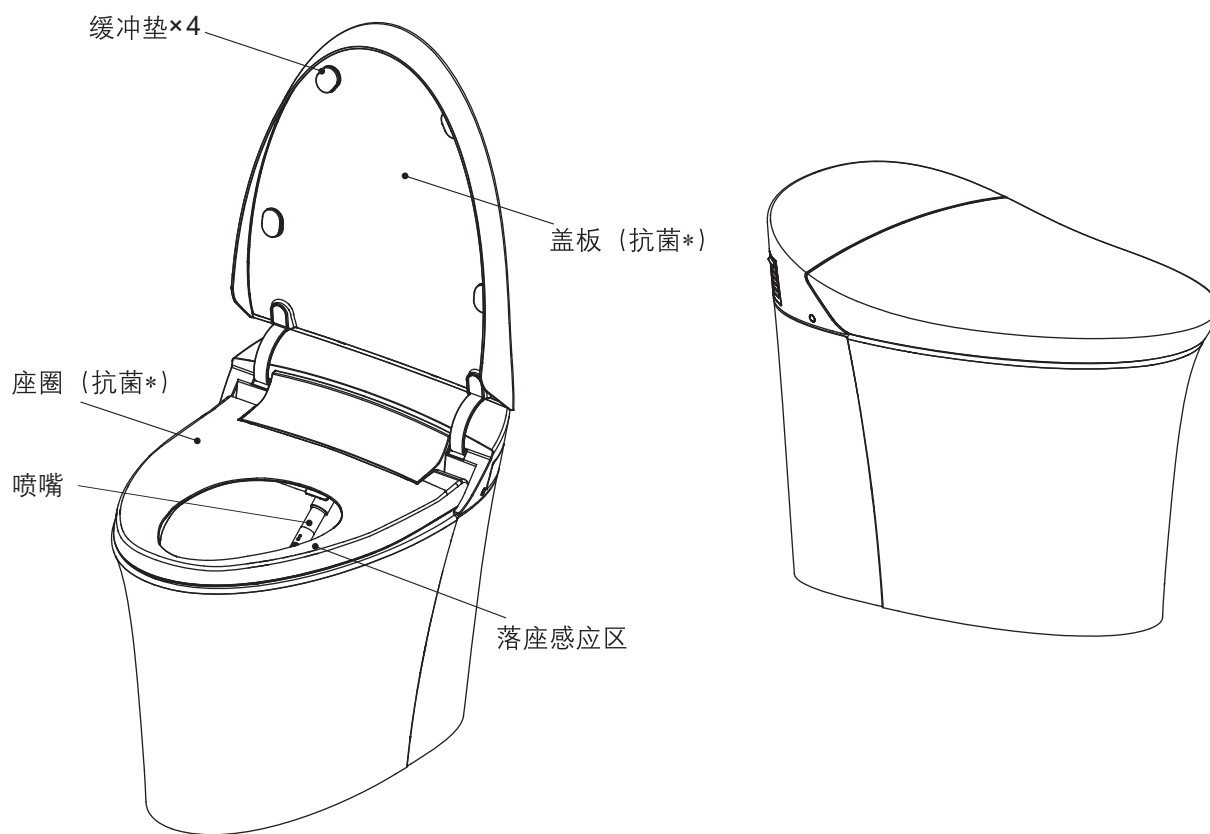

* 抗菌：含无机系抗菌材料的座圈、盖板长期抗菌，抑制产品表面的细菌生长，这一加工处理不代表防霉等附带效果。抗菌率大于90%（依据GB21551.2-2010进行试验。测试机构：中国家用电器检测所、上海出入境检验检疫局机电产品检测技术中心）

遥控器使用指南

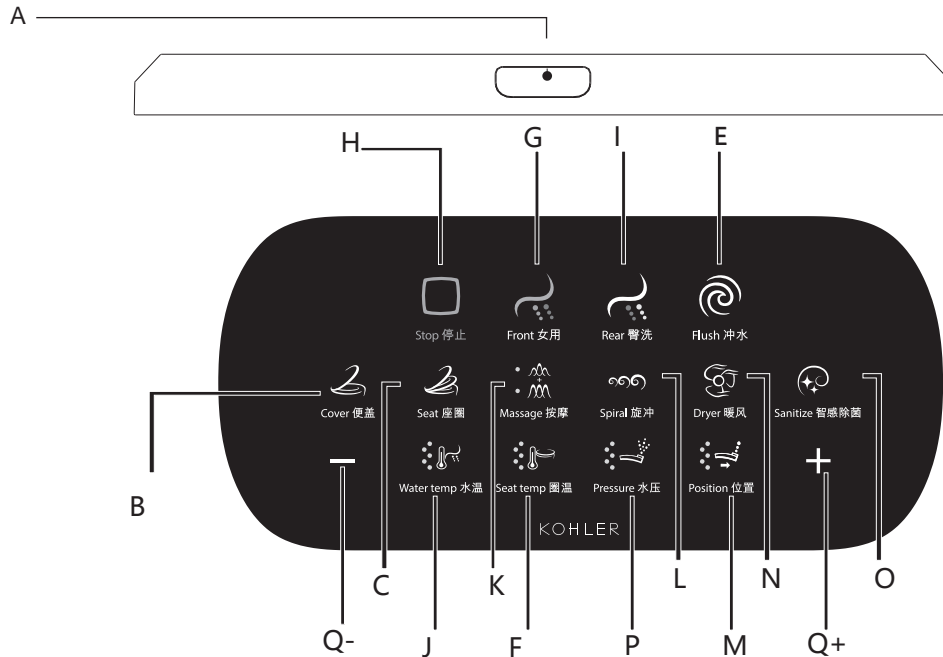

警告：为避免掉落的风险，请从充电座上取下遥控器再按开机键。

A - 开机

按此键进行遥控器开机。开机后按此键可进行开、关屏切换。
开机后若未与坐便器连接上，则第三排图标会闪烁，连接成功后停止闪烁，进入可使用状态。

B - 便盖开/关

离座状态下，可按此键进行开/关盖动作。

C - 座圈开/关

离座时，可按此键进行开、关座圈动作。

E - 冲水

●按此键对坐便器进行冲洗。

F - 圈温

●按此键调整圈温档位，按+/-键（Q+/Q-）调节座圈加热温度。

G - 女性冲洗

落座后，按此键进入女性冲洗，约5分钟后自动停止或按停止键立即关闭。

H - 停止

- 按此键可停止女性冲洗、臀部冲洗、暖风和除臭，手动清洁喷管、UV等功能。
- 长按此键关闭遥控器。

I - 臀部冲洗

落座后，按此键进入臀部冲洗，约5分钟后自动停止或按停止键立即关闭。

本机附带宽幅清洁功能，如想使用宽幅清洁，请同时长按遥控器上的臀部冲洗键和电源键约2秒，然后启动臀部冲洗的移动模式。

J - 水温

●在开启女性冲洗或臀部冲洗后，按此键再按+/-键（Q+/Q-）调节水温。

K - 按摩

在开启女性冲洗或臀部冲洗后，按此键进入移动冲洗，再次按进入脉冲冲洗，第三次按移动/脉冲同时进行，第4次按退出该模式（相应功能启动时，图标左侧的灯亮）。

L - 旋转冲洗

在进行臀部冲洗期间，按此键进行旋转水型冲洗，旋转冲洗图标闪动。再按退出旋转冲洗（或按“停止”键关闭），旋转冲洗图标停止闪动。

M - 位置

- 在开启女性冲洗或臀部冲洗后，按此键再按+/-键（Q+/Q-）调节喷管移动位置。

N - 暖风

落座后，按此键开启暖风功能，约4分钟后自动停止或按停止键立即关闭。

O - 智感除菌

在离座状态，短按此键进入紫外线杀菌功能，图标闪动。

P - 水压

- 在开启女性冲洗或臀部冲洗后，按此键再按+/-键（Q+/Q-）调节水压档位。

Q - 参数调节按键Q+/Q-:

只有触发J/F/P/M功能时，才会激活“+/-”按键进行相应的参数调节。



低电压报警

注意：电压报警后请及时充电。

- 当  键闪烁时，表示遥控器内置电池电量将耗尽，需将遥控器放置在基座上充电；

配对

注意：配对操作只能在离座状态下进行。

- 坐便盖正常上电，按遥控器顶端开机键开机，当最下面一排图标长时间闪烁，即表示该遥控器需要与本体进行配对操作。
- 长按暖风键，当最下面一排图标快闪后开始进行本体端操作。
- 同时长按本体侧键盘的  键和  键，直到听到一声短鸣后放开按键。
- 看到遥控器最下面一排图标停止闪烁，表示配对成功。

遥控器与本机的通讯

- 遥控器被移动离开感应区域，遥控器最下面一排图标会自动闪动（表示寻找主机信号），拿回主机附近后，如主机是通电正常工作状态，将自动连接信号，连接成功后停止闪动。

关机功能

- 任何时候长按  键，遥控器进入关机状态。

遥控器设置指南

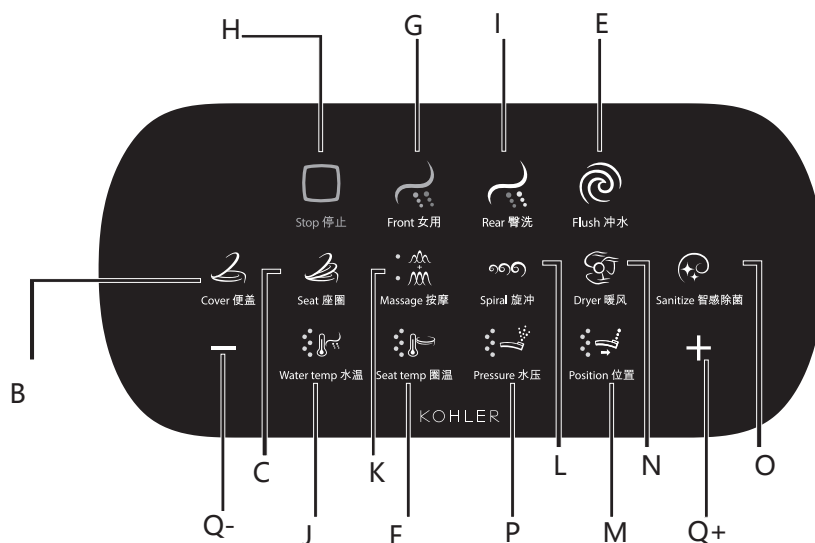

按住本体侧键盘  键, 直到听到一声短音, 同时夜灯闪烁三次后, 放开按键, 随后可按照以下B/C/E/F/I/O变更设置.

B - 便盖开/关...感应距的设置

- 长按进行自动翻盖感应距离设置:
 1. 夜灯快闪一次为近距 (短音)。
 2. 夜灯快闪二次为中距 (短音)。
 3. 夜灯快闪三次为远距 (短音)。
 4. 夜灯慢闪一次则关闭自动翻盖功能 (长音)。

C - 座圈开/关...除臭功能设置

- 长按此键进行开启、关闭除臭功能切换。
 1. 夜灯快闪一次开启除臭功能 (短音)。
 2. 夜灯慢闪一次关闭除臭功能 (长音)。

E - 冲水...自动冲水设置

- 长按此键进行自动冲水功能设置
 1. 夜灯快闪一次开启不关盖自动冲水功能 (短音)。
 2. 夜灯快闪二次开启关盖自动冲水功能 (短音)。
 3. 夜灯慢闪一次关闭自动冲水功能 (长音)。

F - 圈温...节能设置

- 长按圈温键打开节能功能, 再次长按关闭该功能。
 1. 夜灯快闪一次开启节能功能 (短音)。
 2. 夜灯慢闪一次关闭节能功能 (长音)。

I - 臀洗...自动关盖冲水延时时长设置

- 长按此键进行自动关盖冲水延时时长设置
 1. 夜灯快闪一次, 表示短档延时 (短音)。
 2. 夜灯快闪二次, 表示中档延时 (短音)。
 3. 夜灯快闪三次, 表示长档延时 (短音)。

O - 智感除菌设置

- 长按可设置紫外线自动杀菌的开/关状态。
 1. 夜灯快闪一次开启紫外线自动杀菌功能 (短音)。
 2. 夜灯慢闪一次关闭紫外线自动杀菌功能 (长音)。

一定时间不进行B/C/E/F/I/O设置变更后, 下次变更前需要重新用按住本体侧键盘  键, 直到听到一声短音, 同时夜灯闪烁三次.

M - 位置...喷管清洁设置

- 离座状态下, 长按此键启动手动清洁喷管功能, 喷管伸出, 可对喷头进行手动清洗, 再次长按此键或按停止键停止该功能。

遥控器电池的使用及更换

- 遥控器充电座使用4节5号碱性电池。
- 当电量不够时, 充电座会有红灯闪烁, 提示用户需要更换电池。
- 注意:
 1. 电池的正负极必须与遥控器上的标记一致。
 2. 新旧电池不能混用。
 3. 请使用碱性电池。

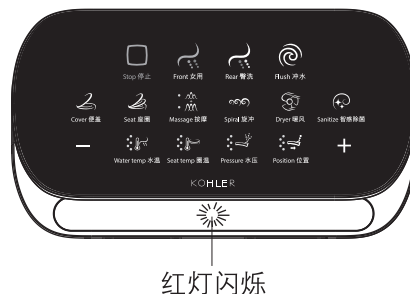

其他

- 请勿将遥控器放在液体可能直接喷淋到的地方，或浸泡在液体中。
- 请勿放置在烘手机、电吹风等小型家电的周围，以免干扰遥控器的正常使用。
- 请勿对遥控器的按键区域频繁、剧烈地施加外力。
- 遥控器使用完毕后，应放回墙上的遥控器支架。
- 在使用过程中，避免遥控器跌落。
- 防遗失功能：遥控器可通过螺丝与底座锁定，具体方法参见安装说明书。

初次使用前准备

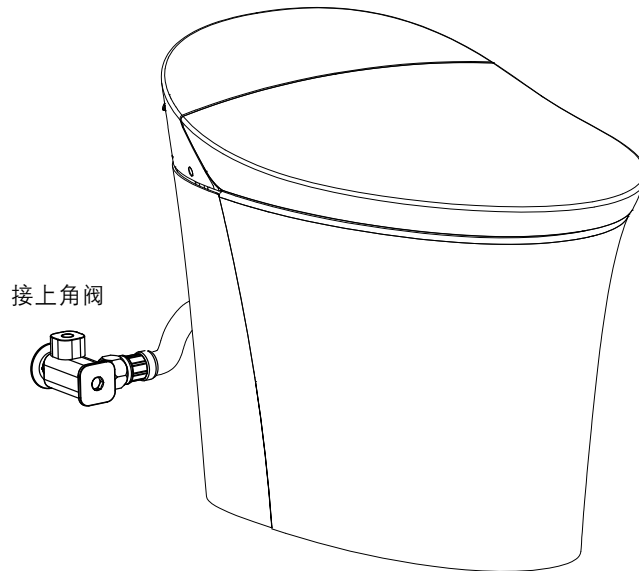

- 确认进水阀是否已打开。
- 确认“遥控器”内已正确装入电池。
- 确认产品正前方没有障碍物。
- 产品通电后，等待主机完成自检。期间可听到电机的转动声和流水声，夜灯闪烁，均属正常。当夜灯停止闪烁时，自检结束。
- 初次使用时为出厂设置状态：

女性冲洗：

- 水温：中档
- 水流强度：中档
- 冲洗位置：第3档

臀部冲洗：

- 水温：中档
- 水流强度：中档
- 冲洗位置：第3档

旋转冲洗：

- 水温：中档
- 水流强度：中档
- 冲洗位置：第3档

圈温：中档

夜灯：开

节能模式：关

自动翻盖功能：开，距离中

自动冲水功能：不关盖自动冲水

智感除菌功能：开

除菌水功能：开

除臭：开

水泵：开（同时长按本体侧

键盘上的冲水键和女性冲洗

键，短音“滴”声表示水泵

开启，长音“滴”声表示水

泵关闭。）

便盖/座圈开关功能

A 便盖开/关

• 自动开、关盖

关盖状态下，当用户进入感应区域时，盖板自动打开。

开盖状态下，当用户离开感应区域后，一段时间后自动关闭。

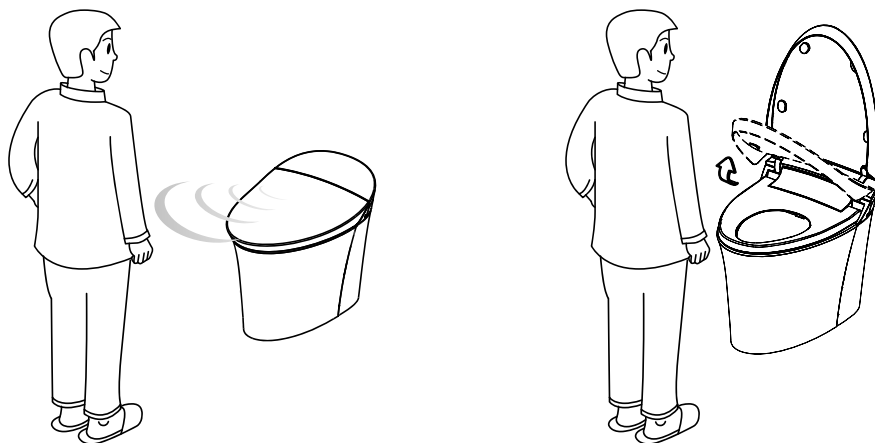

• 遥控器开、关盖

用户没有落座时，按下遥控器上的盖开/关键，则执行相应的开合功能(详见遥控器按钮简图)。用户落座时，按遥控器的  按键无效。

• 手动开、关盖

用户可以用手直接开、关盖。当用户有正常手动开、关盖的趋势时，盖子能够根据这个运动趋势而自动打开或关闭，不需要一直在盖板上保持用力。盖板在运动过程中遇阻碍会自动停下。

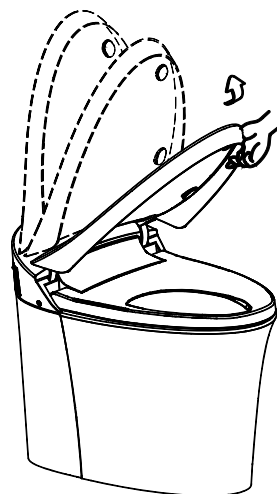

注意：

1. 当用户缓慢进入感应区域时，开、关盖感应距离可能变短。如仍无反应，请使用遥控器或手动开、关盖。
2. 只有在遥控器中的“开/关盖设置”设置为“开”时，自动开、关盖功能才有效（设置方法见第31页）。
3. 避免在坐便器前端40cm内设置可移动的障碍物，若有可移动的障碍物，盖板可能会自动打开；若需要取消“自动开、关盖”功能，请见31页。

B 座圈开/关

• 遥控器开、关圈

用户没有落座时，按下遥控器上的圈开/关键，则执行相应的开合功能(详见遥控器按钮简图)。用户落座时，按遥控器的  按键无效。

• 手动翻圈

用户可以用手直接开、关圈。当用户正常手动开、关圈时，座圈能够根据这个运动趋势而自动打开或关闭，不需要一直在座圈上保持用力。座圈在运动过程中遇阻碍会自动停下。

注：

在盖板及座圈自动开合过程中，严禁强行、大幅度用力等人为因素干扰盖板及座圈的开合。

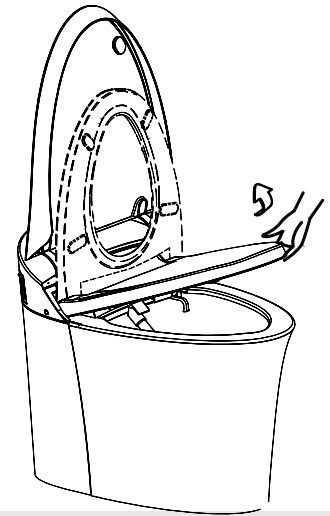

便器冲水

A. 自动冲水功能的使用

a) 使用座圈情况

盖板打开状态下，用户落座使用，当离开座圈一定时间后，便器自动冲水，一段时间后自动关闭。

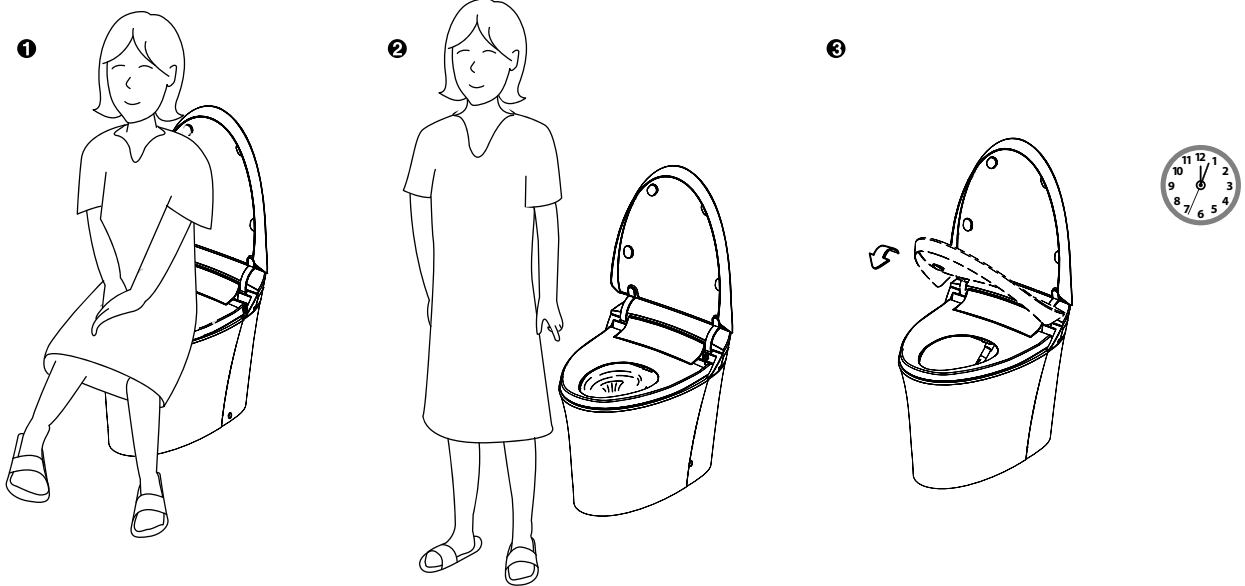

b) 男士小便情况

开盖状态下，用户手动或者使用遥控器翻起座圈，使用后，坐便器自动冲水，一段时间后，盖板、座圈自动关闭。

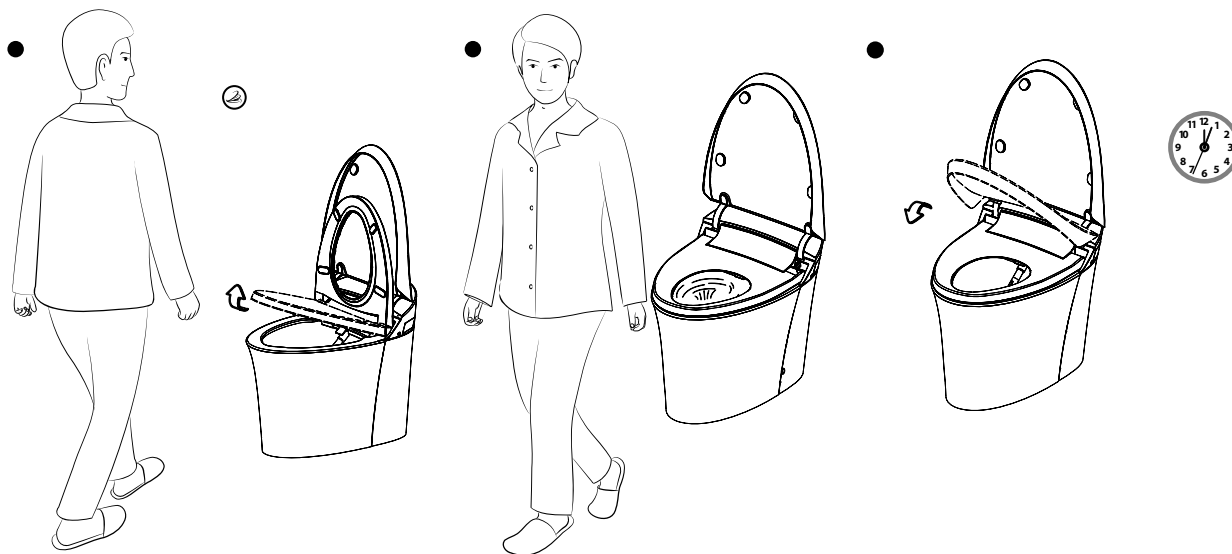

注：

1. 如果自动冲水功能关闭，用户可以用遥控器控制冲水，或手动按键冲水，或手工用盆冲水。
2. 只有在遥控器中的“冲水设置”设置为“开”时，自动冲水功能才有效（设置方法见第31页）。

B. 遥控器控制冲水

用户通过按遥控器上的冲水键，执行坐便器冲水功能。

注：遥控器冲水功能在冲水完成前，不会执行第二次。

C. 应急冲水

当停电时，请长按本体上辅助键盘冲水按键，

启动应急冲水功能。

注：本功能使用的电源为内置碱性电池。

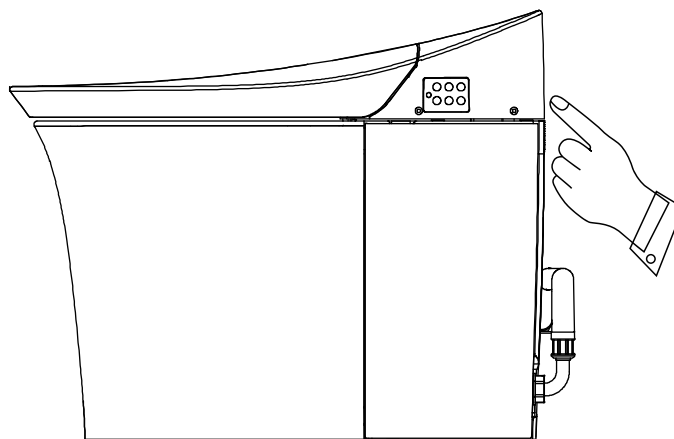
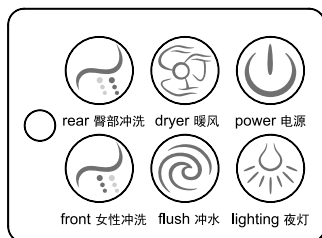

D. 手工用盆冲水

当应急冲水功能失效时，盖和圈翻起，用盆盛水冲走坐便器中的污物。

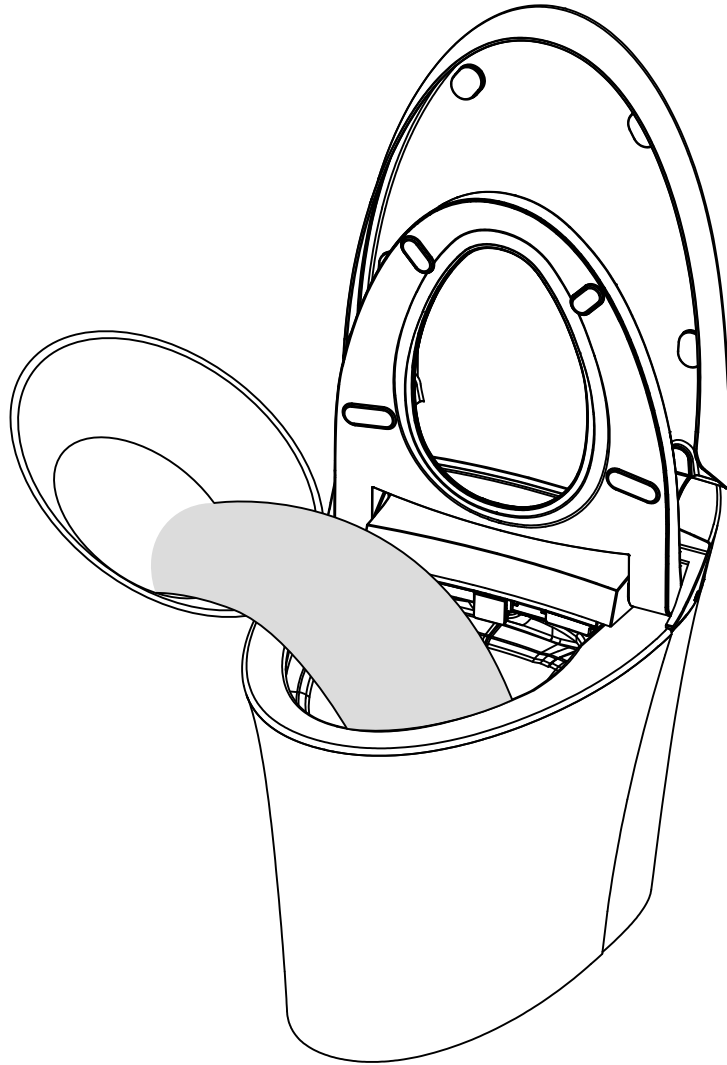

辅助键盘功能

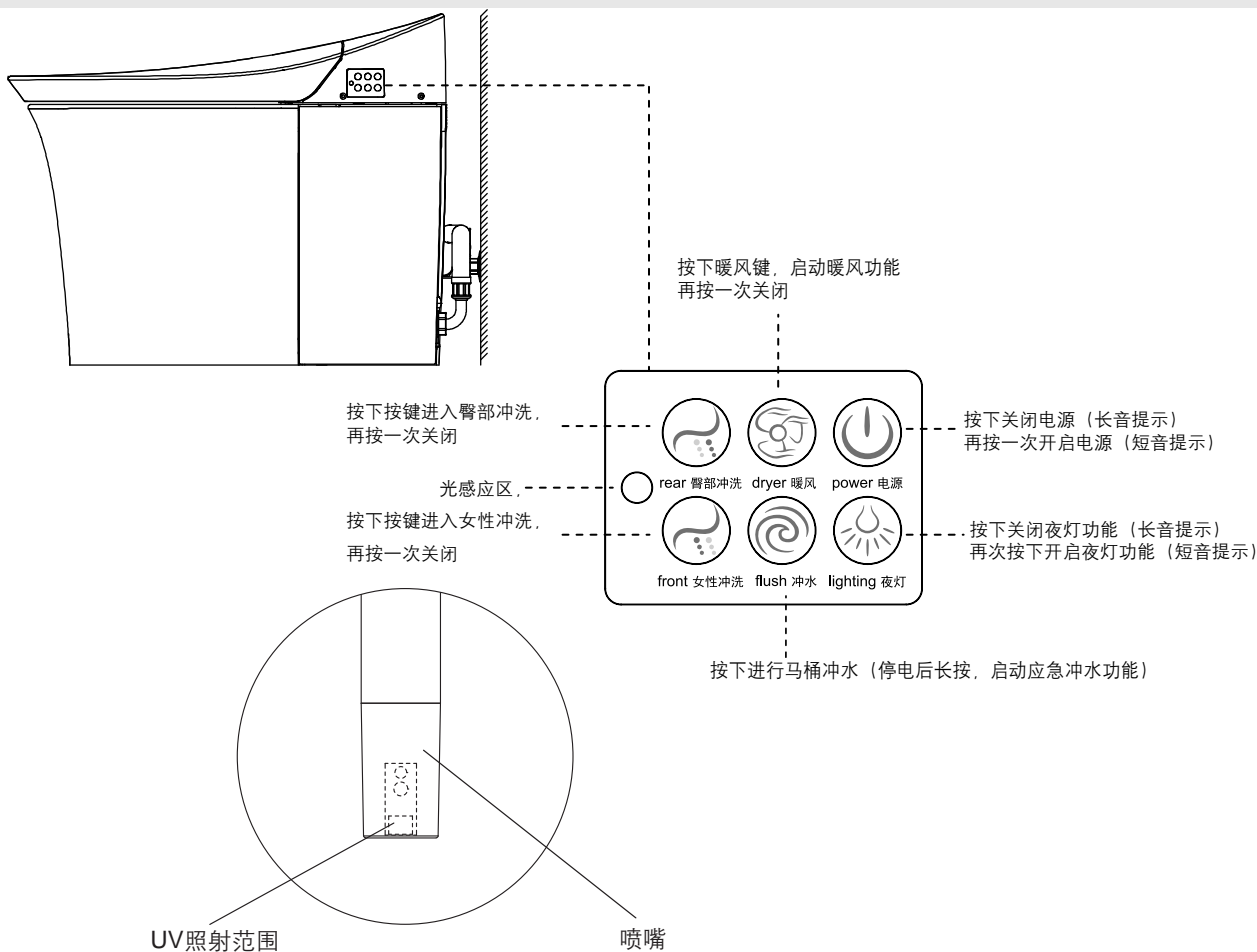

注：

1. 各功能均按出厂设置运行。
2. 在使用女性冲洗、臀部冲洗功能时，再按一次，关闭该功能，否则5分钟后自动关闭。
3. 在使用暖风功能时，再按一次，关闭该功能，否则4分钟后自动关闭。

待机模式

1. 按辅助键盘上的电源按键，听到“嘀”一声后，进入待机模式。此时，自动感应及遥控功能关闭，座圈加热功能将被停止，以最大限度降低能耗。
2. 当再次按辅助键盘上的电源按键后，退出待机模式，所有功能恢复。

智感除菌功能*

- 智感除菌是通过UV紫外线对喷管进行消毒来实现的。
- 自动UV除菌
 - 如果长时间无人使用，将自动启动UV除菌功能，对喷管进行除菌。除菌结束后24小时之内不会再次启动该功能。
 - UV除菌过程中，如果有用户来打开盖子落座使用坐便器，或者按下遥控器上的停止键，UV除菌功能将关闭。
 - 自动UV除菌功能设置请参见第31页。
- 手动UV除菌
 - 在离座情况下，短按遥控器UV按键将立即执行UV除菌功能。
 - UV除菌过程中，如果有用户来打开盖子落座使用坐便器，或者按下遥控器上的停止键，UV除菌功能将关闭。

* UV除菌（是指UV灯产生紫外线除菌）：在UV工作周期内通过照射对喷嘴表面进行除细菌。除菌率大于99%（在UV的一个工作周期后于18mm×8mm的照射区域内依据GB/T 23131进行试验，UV照射区域见示意图，UV工作周期开启方式见操作说明。测试机构：中国家用电器检测所）

除菌水*

- 除菌水功能是使用除菌水对喷头进行除菌的一种功能。
- 用户在使用过女性冲洗、臀部冲洗或旋转冲洗等功能，起身离开坐便器后，坐便器将启动除菌水除菌功能。
- 没有人使用坐便器的时候，每8个小时自动启动一次除菌水除菌。

* 除菌水（是指水电解装置电离自来水中的氯离子生成含次氯酸的水）：在电解水工作周期内产生的除菌水对喷嘴表面进行除细菌。除菌率大于96%（在自来水中氯离子含量大于24ppm时依据GB/T 23131进行试验，各地水质不同可能导致除菌效果不同，电解水工作周期开启方式见操作说明。测试机构：中国家用电器检测所）

自动节能功能

- 在节能设置为开的情况下，产品会自动检测到使用频率低的时间带，并将便座加热温度下降以达到节电的目的。
- 自动节能设置参见第31页。

维护和清洗

A. 常规清洗

为了达到最好的效果，在维护您的科勒产品时记住下列几条：

重要！不要用水直接冲洗坐便盖（包括遥控器）

- 测试-首先用清洗液在坐便盖不显眼的地方测试，如果确认清洗液不会对坐便盖外表造成损坏然后再应用于整个表面。
- 不要让清洁剂浸泡-不要让清洁剂浸泡产品。
- 避免表面粗糙的材料-使用柔软、潮湿的海绵或棉质布，不要用表面粗糙的材料来清洗表面，诸如刷子、冲刷垫等。
- 擦洗-加上清洁剂后，立即用湿布擦洗表面，擦除喷到表面的清洁剂和脏物。

清洗座圈

- 在用于清洗的气雾罐中避免使用具有研磨的清洁剂和消毒剂。

维护提示：用洗涤剂和水混合液体或任何列为可用于座圈清洁的产品清洗座圈，用柔软湿润的海绵或者布。用软毛巾擦干，在空气中让座圈自然干燥。

- 不允许带腐蚀的化学品或化妆品（诸如指甲油或须后水）和座圈接触，避免破坏表面。

清洗不锈钢外观件

- 以中性肥皂水清洗表面，再以干净的软布彻底擦干整个表面。许多清洁剂，比如氨水、去污粉及洁厕灵等，会对表面造成伤害，切忌使用。

注意：不遵守这些清洗说明可能使科勒的保修义务无效。

注意：清洗程序的成功取决于诸如水的硬度和温度，使用成分的精确数量，清洗规则的改变和被清洗产品的状态等因素。因为这些因素会有变化，科勒不能保证所提到的规则的有效性。

注意：清洁翻起的圈盖时，不能过度用力，以免损坏产品。

清洁铰链臂

定期用柔软抹布擦拭铰链臂，以防止铰链臂沾有污垢，导致光亮度降低。



B. 喷嘴的清洗

用户使用软毛刷清洁臀部/女性喷嘴的方法：

- 在离座状态下，长按“遥控器”上的“位置”按键2秒钟以上，或长按侧键盘的前冲或后冲键，喷管会伸出。
- 用户可以使用软毛刷沾水对喷嘴进行清洗。
- 再按一次上述按键之一或遥控器上的停止键，喷管缩回，或两分钟后喷管自动缩回。

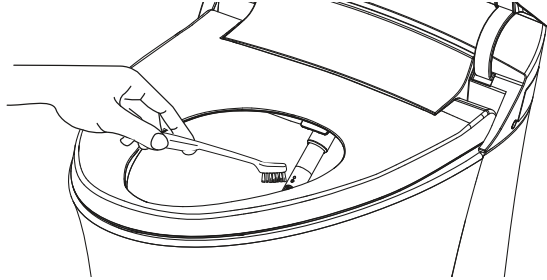

用户拆除喷头的清洗方法：

- 在离座状态下，长按“遥控器”上的“移动冲洗”按键2秒钟以上，或长按侧键盘的前冲或后冲键，喷管会伸出。
- 在两分钟之内断掉马桶电源。
- 沿图示箭头方向拔掉喷嘴。

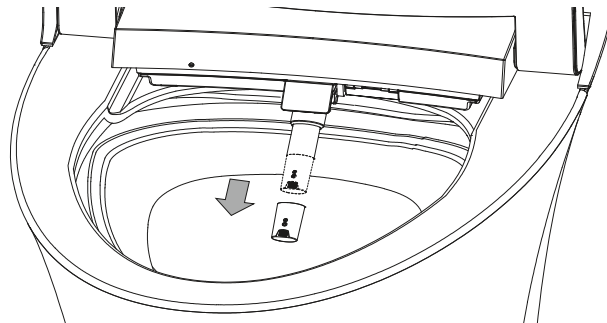

- 将喷嘴浸没在除垢剂溶液中2个小时。
- 用软毛刷清洗干净。

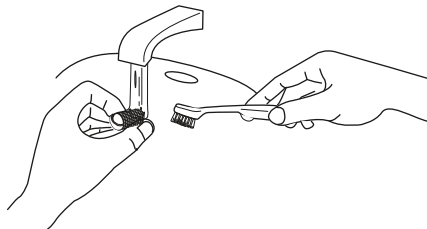

- 按拆除方向把喷嘴装回到初始位置。
- 上电检查喷管冲洗功能。

C. 滤网的清洗或更换

用户发现冲洗水量变小或出现不出水现象，请及时清洗或更换滤网。

坐便器滤网清洗

- 拔掉电源，关闭角阀，取下滤网塞。

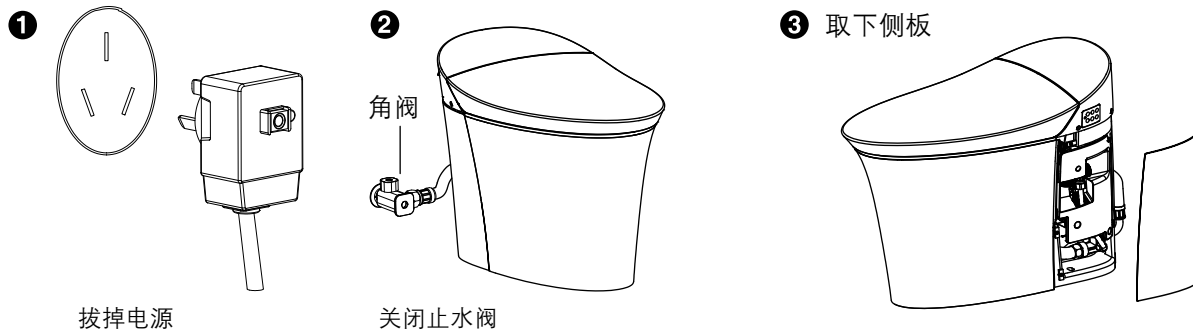

- 取出滤网，清洗滤网。

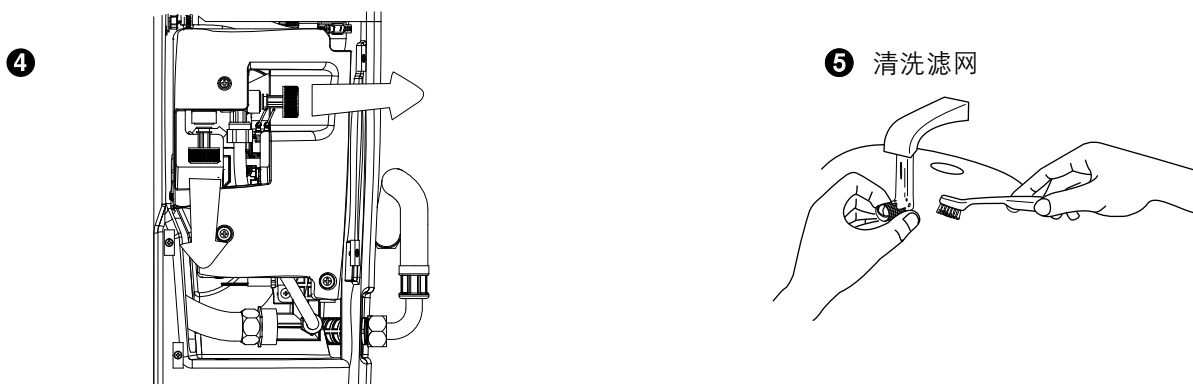

- 重新装好滤网，接上软管接头，打开角阀。
- 检查连接处，无任何水渗漏后，插上电源。
- 将侧板装回原位。

角阀滤网清洗

- 1 拔掉电源
- 2 关闭角阀，取下过滤盖
- 3 取出滤网
- 4 清洗滤网

更换滤网步骤同上。

注：
如果发现滤网已损坏或者堵塞很严重，请及时更换，
滤网目数不得低于80目。

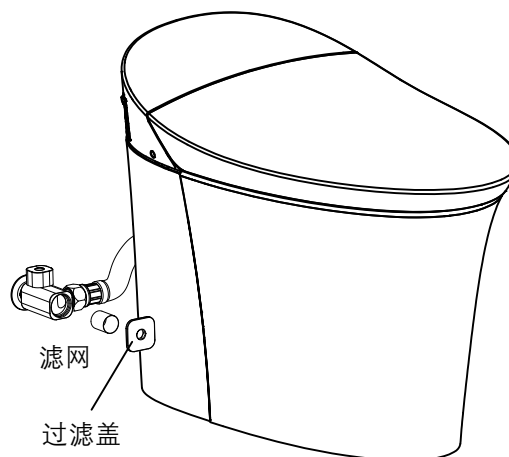

D. 除臭块的更换

用户发现除臭效果不明显，感觉有异味时，请及时更换除臭块。

更换除臭块步骤：

- 取出除臭百叶窗及除臭块。

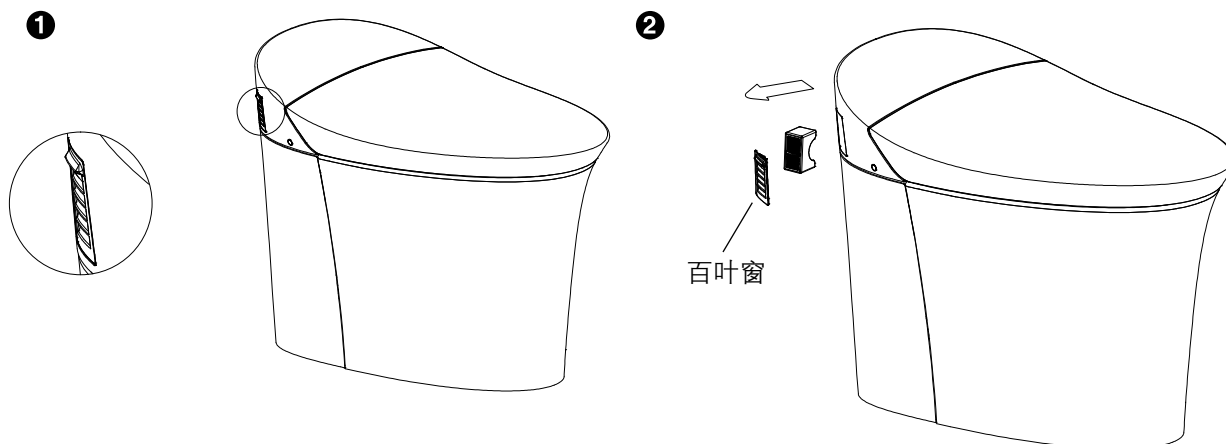

- 更换新除臭块后，重新放回机体即可。

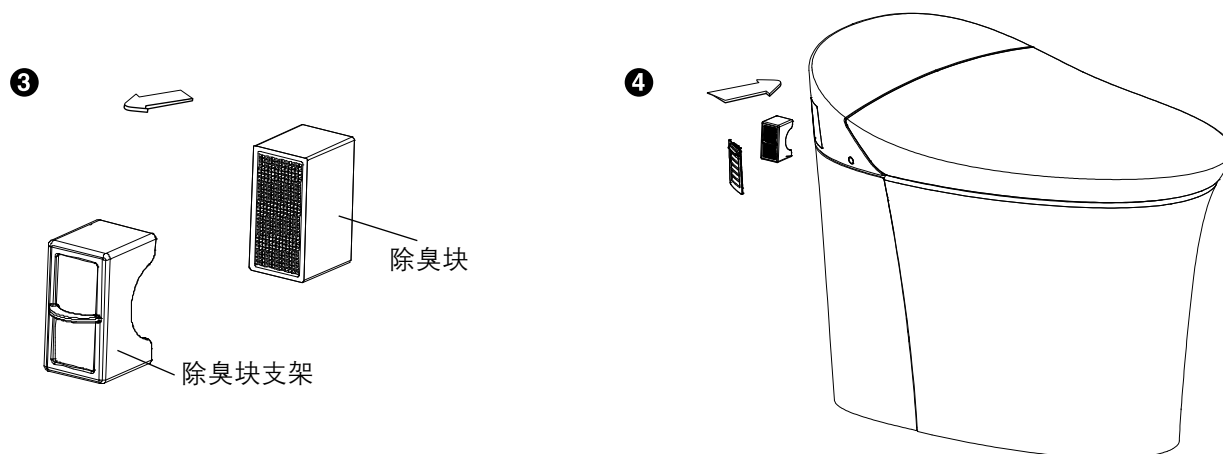

注：

取出除臭块后，请勿将手和其他物体伸入除臭块容纳腔内，以防损坏风机和其他部件。



扫码查看替换装，型号：22761T-NA。

E. 长期放置不用时的维护

a) 如果准备长期不使用智能坐便盖，务必排尽坐便盖内部管路中的积水：

- 拔掉电源，关闭角阀，使用细棒长按入小孔内的加热管的泄水按钮，排空加热管内的积水。

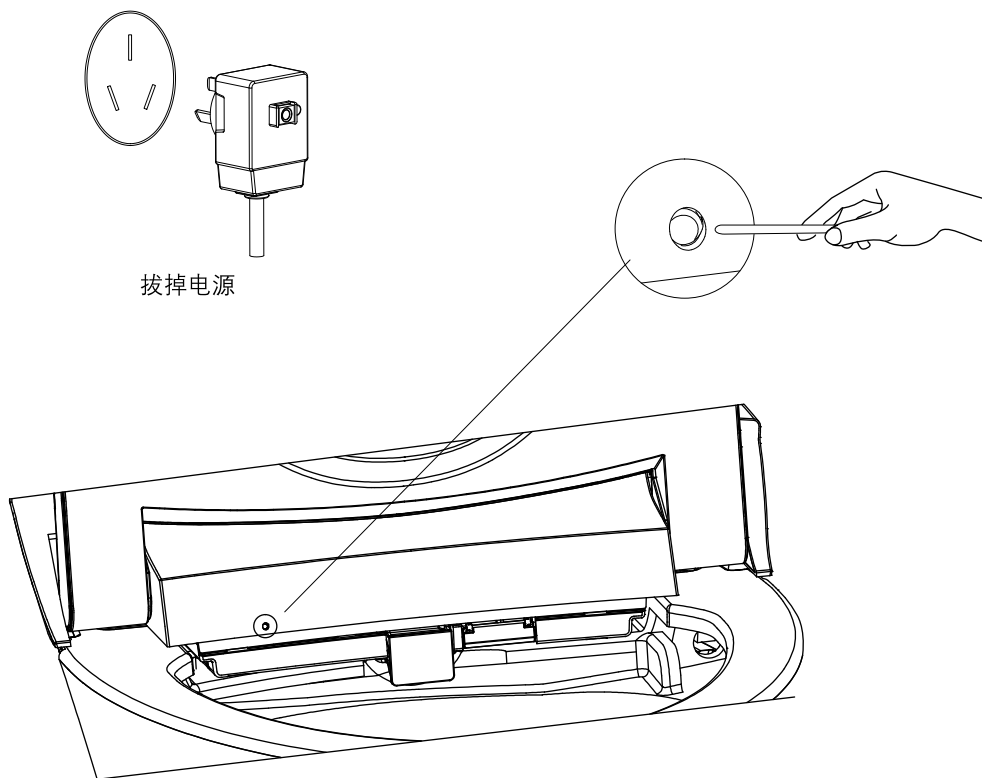

注：

1. 如果没有排尽积水而又长时间不使用该产品，残留水冬天容易冻结夏天容易变质。
 2. 冬天发现家中的供水管道已经冻结，不要马上使用智能坐便盖，可以升高室内的温度，等待其自然解冻后再使用。
 3. 冬天当温度可能超出正常的工作温度，且水管有结冰的风险时，请关闭角阀，并对马桶进行一次冲水。
 4. 长期不用时，请关闭角阀，并对马桶进行一次冲水。
 5. 长期不用后再次使用时，请务必多进行几次冲洗，确保内部管路清洗干净。
 6. 长期不使用取出遥控器充电座中的电池。
- b) 长期放置不用时，可能会由于马桶里面水分挥发完毕后，下水道的有害气体溢出导致塑料件变黄风险，打开上盖或往马桶里面加水可有效避免该问题。

常见问题

本指南仅作一般帮助之用。科勒公司授权的服务代表或者合格电工应当能够解决所有的电气问题。如需了解担保服务，请联系您当地的经销商或批发商。

现象	可能原因	建议措施
1. 坐便器不工作	A. 停电 B. 插头未插或者插座无电 C. 电源线插头上漏电保护开关未复位 D. 产品处于待机状态	A. 等到电力恢复 B. 插上插头或者检测电源插座 C. 按下插头上的复位按钮 D. 按一下侧面power按键，唤醒产品
2. 坐便器不冲水	A. 停水 B. 供水角阀关闭 C. 停电 D. 产品处于待机状态 E. 清洗功能正在使用中 F. 自动冲水功能被禁止	A. 等到恢复供水 B. 打开供水角阀 C. 等待恢复电力或者长按本体上辅助键盘冲水按键或者用盆盛水冲洗。 D. 按一下侧面power按键，唤醒产品 E. 待清洗功能完成再进行 F. 查看“遥控器设置指南”部分
3. 应急冲水不工作	A. 后备电池包电量低	A. 联系科勒售后服务，更换电池包
4. 坐便器冲不干净	A. 过滤网阻塞 B. 供水水压不足 C. 水泵未工作	A. 查看“清洗过滤网”部分 B. 检查角阀是否全部打开，如未全部打开，请打开；检查进水软管是否折弯过急，如折弯过急，请调整软管 C. 重新上电，若重复出现此现象，请联系科勒售后
5. 清洗功能无法正常使用	A. 停水 B. 供水角阀关闭或者未完全打开 C. 产品处于待机状态 D. 没有入座或者当前坐姿无法使座圈感应到 E. 过滤网阻塞 F. 供水水压不足 G. 坐便器正在冲水中	A. 等到恢复供水 B. 完全打开供水角阀 C. 按一下侧面power按键，唤醒产品 D. 请入座或者调整坐姿 E. 查看“清洗过滤网”部分 F. 检查进水软管是否折弯过急，如折弯过急，请调整软管 G. 等待冲水完成后再冲洗
6. 使用过程中冲洗功能停止工作	A. 连续冲洗5分钟后冲洗功能自动停止 B. 座圈未感应到人体	A. 如需要，请再次按下冲洗按键 B. 变换坐姿或者重新入座
7. 人体未入座时也能使用清洗功能	A. 座圈上有异物覆盖或者座圈是湿的	A. 移除异物或者擦干座圈
8. 使用过程中暖风风机停止工作	A. 连续使用暖风功能4分钟，风机自动停止 B. 座圈未感应到人体	A. 如需要，请再次按下暖风按键 B. 变换坐姿或者重新入座
9. 除臭风机不工作	A. 座圈未感应到人体 B. 使用过程中误按停止键 C. 自动除臭功能被禁止	A. 变换坐姿或者重新入座 B. 如需要，请离座2秒后重新入座 C. 查看“遥控器设置指南”部分
10. 不能开关盖	A. 座圈上有异物覆盖或者座圈是湿的 B. 便盖在先前开关过程中受到人为干扰	A. 移除异物或者擦干座圈 B. 使用遥控器开关便盖或手动打开便盖直至正常，便盖开关过程中不阻挡其开关
11. 不能自动开关盖	A. 用户没有进入或离开感应区域 B. 遥控器“自动翻盖”功能被关闭 C. 坐便器正在冲水中	A. 请进入或离开感应区域 B. 查看“遥控器设置指南”部分 C. 等待坐便器冲水结束
12. 夜灯不亮	A. 夜灯功能被关闭 B. 室内光线太亮	A. 查看“辅助键盘功能”中的夜灯部分来打开夜灯功能 B. 请关闭室内灯光并拉上窗帘
13. 智感除菌不工作	A. 有人坐在坐便器上 B. 座圈上有异物覆盖或者座圈是湿的	A. 请离座后再重新开启智感除菌。 B. 移除异物或者擦干座圈

14. 遥控器无显示	A. 电池电量耗尽 B. 电池极性装反 C. 遥控器未被唤醒	A. 更换新电池 B. 重新正确安装 C. 触摸遥控器屏幕 靠近坐便器或落座 按遥控器唤醒键
15. 遥控器无法遥控坐便器	A. 电池电量不足 B. 遥控器离坐便器太远 C. 坐便器本体没有上电 D. 坐便器本体处于待机状态 E. 坐便器与遥控器未连接	A. 查看“遥控器电池的使用及更换”部分来更换电池 B. 查看“遥控器与本机的通讯”部分并靠近坐便器 C. 请给本体上电 D. 按一下侧面power按键，唤醒产品 E. 查看“遥控器与本机的通讯”部分，连接坐便器与遥控器
<p>如要检修此坐便器，您必须首先：</p> <p>拔下坐便器电源插头</p> <p>如有需要，打开供水阀。</p>		
This area is intentionally left blank for troubleshooting steps		

产品中有害物质含量的说明

回收提示

本产品超过使用期限或经过维修无法正常使用后，不应随意丢弃，请交由有废弃电器电子产品处理资质的企业处理，正确的处理方法请查阅国家或当地有关废旧电器电子产品处理的规定。

有害物质统计表

部件名称	有害物质名称					
	铅 (Pb)	汞 (Hg)	镉 (Cd)	六价铬 (Cr (VI))	多溴联苯 (PBB)	多溴二苯醚 (PBDE)
塑料组件	○	○	○	○	○	○
控制类组件	×	○	○	○	○	○
PCBA组件	×	○	○	○	○	○
电机类组件	×	○	○	○	○	○
导线类组件	○	○	○	○	○	○
进水组件	○	○	○	○	○	○
喷管组件	○	○	○	○	○	○
加热组件	×	○	○	○	○	○
* 遥控器组件	×	○	○	○	○	○
* 电池	○	○	○	○	○	○
* 陶瓷类组件	○	○	○	○	○	○
* 水箱组件	○	○	○	○	○	○

本表格依据SJ/T 11364的规定编制。

○：表示该有害物质在该部件所有均质材料中的含量均在GB/T 26572现行有效版本规定的限量要求以下。

×：表示有害物质至少在该部件的某一均质材料中的含量超出GB/T 26572现行有效版本规定的限量要求。

*：表示部分机型含有该部件。

注：本表格提供的信息是基于供应商提供的数据及科勒公司的检测结果。本产品应用环保设计理念，在当前技术水平下，所有有害物质或元素的使用已经控制到了最低程度，科勒公司会继续努力通过改善现有技术来减少这些物质的使用。



本产品的“环保使用期限”为10年，科勒公司根据产品设计特性指定该期限。只有在本产品使用说明书所述的正常情况下使用本产品时，“环保使用期限”才有效。